



PTO-X DRIVEN - GRASS COLLECTION SYSTEM

MODEL#: 38651203



Eagle HP

Deck Sizes: 60" & 72"
Model Year: 2021 - Newer

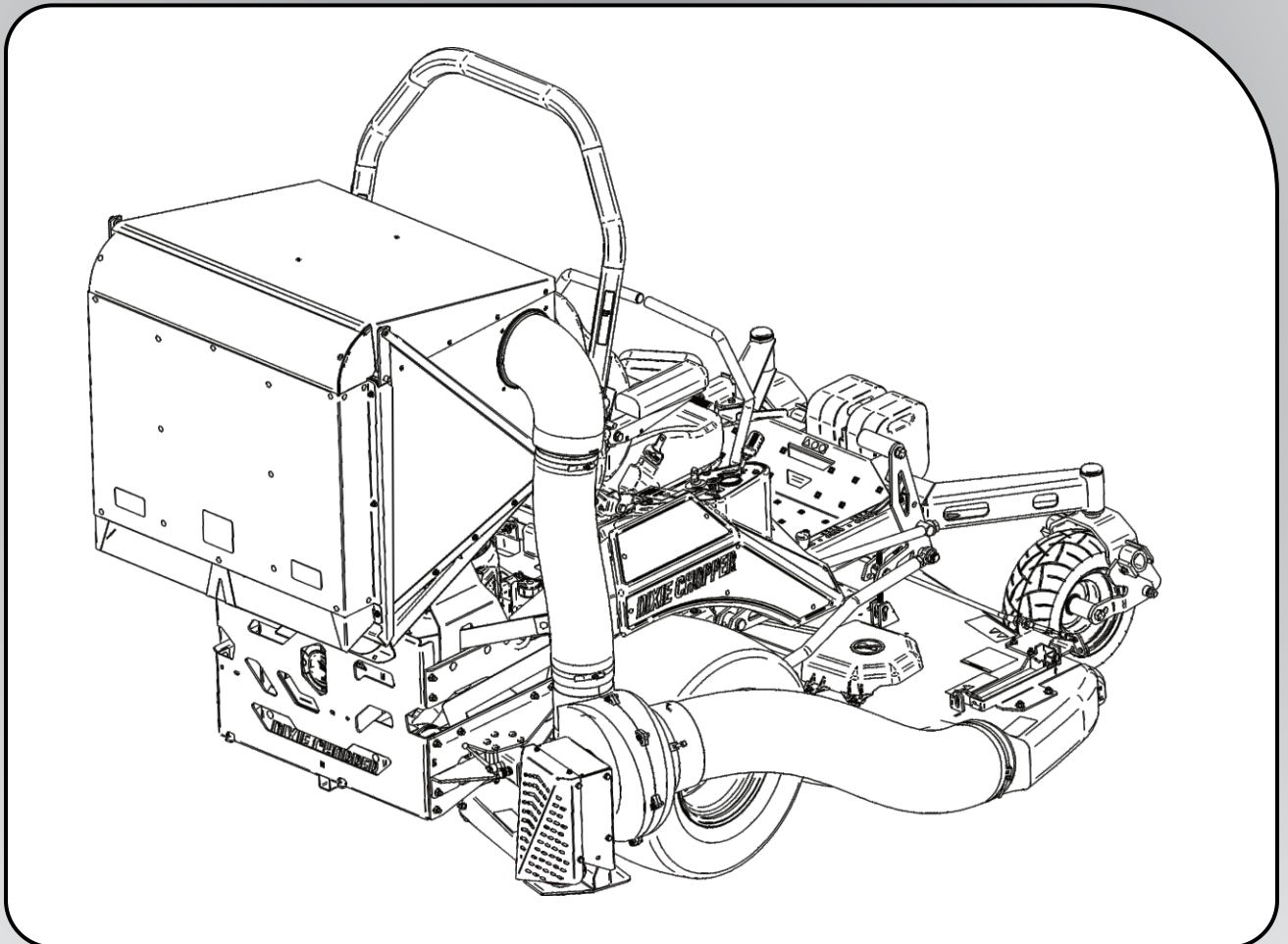

Model Year: 2021 - Newer

OPERATOR'S MANUAL

ASSEMBLY • OPERATION • MAINTENANCE

GRASS COLLECTION SYSTEM

TABLE OF CONTENTS

| SECTION | PAGE | SECTION | PAGE |
|---|-------|--|-------|
| Safety | 2 | Wiring Harness Installation | 23-24 |
| Safety Alert Symbols | 3 | Length of Hose Adjustment | 25 |
| Warranty | 4 | Upper Hose Installation | 25 |
| I INTRODUCTION AND DESCRIPTION | 5 | Lower Hose To Blower Cone Installation | 25 |
| Introduction | 5 | Lower Hose To Boot Installation | 25 |
| Description | 5 | Impeller Blade Removal/Replacement | 26 |
| II INSTALLATION FOR USE | 6 | Weight Kit Installation | 27-29 |
| Preparation Of Mower | 6 | Exploded Views & Parts List | 30-41 |
| Parking Cable Mount | 7 | Overall Parts List | 42 |
| Top Side Frame Bracket Installation | 7 | Safety Decals | 43 |
| Side Frame Bracket Installation | 9-10 | III OPERATING INSTRUCTIONS | 44 |
| Main Frame Bracket Installation | 11 | General Safety | 44 |
| Mount Arm / Receiver Tube Assy & Exhaust Shield | | Operation & Tips On Mowing | 44 |
| / Top Installation | 12 | Disengagement Of The PTO Assembly | 44 |
| Exhaust Shield / Bottom Installation | 12 | Unloading The Collection System | 44 |
| Main Frame Leg Installation | 13 | IV MAINTENANCE | 45 |
| Main Frame Assembly Installation | 14 | Maintenance Checklist | 45 |
| PTO Drive Assy | 15-16 | Lubrication | 45 |
| Drive Assy & Belt Installation | 17 | V PARTS AND SERVICE | 45 |
| Boot Kit Installation | 18 | Parts And Service Information | 45 |
| Lift Handle Installation | 19 | Torque Specifications | 46 |
| Aluminum Box Assy Installation | 20 | Troubleshooting | 47 |
| Dump Mechanism Adjustment | 21 | | |
| Inlet, Inlet Ring & Debris Deflector Installation | 22 | | |

SAFETY

1. Read the operator's manual carefully and familiarize yourself with the proper use of your attachment. Do not allow anyone who is not acquainted with the Safety Instructions to use your attachment.
2. Know the controls and how to stop them quickly. READ THE OPERATOR'S MANUAL!
3. Do not allow children to operate the machine. Do not allow adults to operate it without proper instruction.
4. Be especially watchful of children and pets entering into the area while operating.
5. Keep your eyes and mind on your machine while mowing or operating your attachment. Don't let others distract you.
6. Do not attempt to operate your machine when not in the driver's seat.
7. Always shut off blades and engine when emptying the container.
8. Stop machine, shut off deck attachment, set parking brake, shut off engine and remove ignition key before removing clogs, removing or replacing hose, boot, blower cone, or performing any maintenance.
9. Mow across the face of slopes (not more than 10 degrees); never up and down the face.
10. It is recommended that the collection bags be emptied when half full while operating on slopes. Start mowing on slopes when the collection bags are empty.
11. Inspect your lawn and remove any foreign objects before mowing. Never deliberately run the mower across any foreign object.
12. Wear hearing protection.
13. Wear eye protection to prevent debris from getting into your eyes.

SAFETY

WARNING! NEVER operate the mower unless the discharge guard and either the deflector assembly or the vacuum collector adapter are fastened securely in place.

WARNING! Do not work around the mower deck boot or the blower area until you are certain that the mower blades and the blower impeller have stopped rotating.

WARNING! To avoid serious injury, perform maintenance on the vacuum collector; **ONLY AFTER STOPPING THE MOWER'S ENGINE AND WAITING FOR ALL MOVING PARTS TO COME TO A COMPLETE STOP.** Set the parking brake. Always remove the ignition key before beginning maintenance.

WARNING! For your own personal safety, **ALWAYS mow ACROSS the face of slopes and NEVER UP and DOWN the face. NEVER attempt to mow excessively steep slopes, and use caution when turning on any slope.**

Safety Alert Symbol



This Safety Alert Symbol means: **“ATTENTION! BECOME ALERT! YOUR SAFETY IS INVOLVED!”**

This symbol is used to call attention to safety precautions that should be followed by the operator to avoid accidents. When you see this symbol, carefully read the message that follows and heed its advice. Failure to comply with safety precautions could result in death or serious bodily injury.

Safety Signs

The signal words **DANGER**, **WARNING**, and **CAUTION** are used on the equipment safety signs. These words are intended to alert the viewer to the existence and the degree of hazard seriousness.



White letters on **RED**

This signal word indicates a potentially hazardous situation which, if not avoided, will result in death or serious injury.



Black letters on **ORANGE**

This signal word indicates a potentially hazardous situation which, if not avoided, could result in death or serious injury.

It may also be used to alert against unsafe practices.



Black letters on **YELLOW**

This signal word indicates a potentially hazardous situation which, if not avoided, will result in minor or moderate injury.

It may also be used to alert against unsafe practices.

PECO LIMITED WARRANTY FOR NEW PRODUCTS

New PECO, Inc. extends the following warranties to the ORIGINAL PURCHASER of each New PECO, Inc. consumer product purchased from one of our Dealers or directly from New PECO, Inc., subject to the following limitations:

A. ITEMS COVERED UNDER WARRANTY

1. **PRODUCT WARRANTY** – Any part or parts which are deemed defective in material or workmanship, as delivered to the original purchaser, will either be repaired or replaced, as New PECO, Inc. elects, without charge for parts or labor, if the defect appears within 12 months from the date of purchase of the product to the Original Purchaser.
2. **PARTS REPLACED DURING WARRANTY** – Any New PECO, Inc. part which is furnished in performance of this warranty and is defective in material or workmanship as delivered to the purchaser will be repaired or replaced, as New PECO, Inc. elects, before the expiration of the original warranty period.

B. WARRANTY DISTINCTIONS

1. **RESIDENTIAL** - Products put to a personal use around a single household or residence are considered Residential. Products designated as “Residential” are warranted for 12 months from the date of purchase of the product, to the ORIGINAL PURCHASER with proof of purchase, when used for or in residential applications.
2. **COMMERCIAL** – Products put to any business use (agricultural, commercial or industrial) or used at multiple locations are considered Commercial. Products designated as “Commercial” are warranted for 12 months from the date of purchase of the product, to the ORIGINAL PURCHASER with proof of purchase, when used for or in commercial applications. Products designated as “Residential” are warranted for 90 days from the date of purchase of the product, to the ORIGINAL PURCHASER with proof of purchase, when used for or in Commercial applications.
3. **RENTAL** – Products used for Rental or Lease Purposes are warranted for 45 days from date of purchase of the product, to the ORIGINAL PURCHASER with proof of purchase, when used for or in a rental business.

C. ITEMS NOT COVERED BY NEW PECO WARRANTY

1. **ENGINES & BATTERIES:** Engines and Batteries attached to New PECO, Inc. products are covered under their respective separate manufacturer warranties and those companies must be contacted directly to file a warranty claim. Briggs & Stratton: https://www.briggsandstratton.com/na/en_us/support/warranty.html
2. **UNAPPROVED ALTERATION OR MODIFICATION:** All obligations of New PECO, Inc. under this warranty shall be terminated if products are altered or modified in any way not approved by New PECO, Inc.
3. **ACCIDENTS & NORMAL MAINTENANCE:** This warranty covers ONLY manufacturers defective material and workmanship. It does not cover depreciation or damage caused by normal wear & tear, accident, improper maintenance, misuse or abuse of products. New PECO, Inc. products must be operated and maintained in accordance with the instructions furnished in the manuals. The cost of normal maintenance and normal replacement of service items such as belts, cutting blades, hoses, bags, etc., which are not defective shall be paid for by the purchaser.
4. **NO SERVICE CENTER WARRANTY:** The selling Service Center/Dealer makes no warranty on his own on any item warranted by New PECO, Inc. unless he delivers to purchaser a separate written warranty certificate specifically warranting the item. The Service Center or Dealer has no authority to make any representation or promise on behalf of New PECO, Inc. or to modify the terms of the original warranty in any way.
5. **NO REPRESENTATIONS ADDITIONAL WARRANTIES, DISCLAIMER:** Neither New PECO, Inc. nor any company affiliated with New PECO, Inc. makes any warranties, representations or promises as to the quality of performance of its products other than those set forth herein. Except as described above, New PECO, Inc. makes no other warranties **AND SPECIFICALLY DISCLAIMS ANY AND ALL IMPLIED WARRANTIES OF FITNESS AND MERCHANTABILITY.**
6. **REMEDIED EXCLUSIVE:** The only remedies the purchaser has in connection with the breach or performance of any warranty on New PECO, Inc. consumer products are set forth above. In no event will New PECO, Inc. be liable for special incidental or consequential damages.

Warranty service is available through your local authorized service dealer or distributor. If you do not know the dealer or distributor in your area, search by your zip code on www.lawnvac.com or contact our Sales Department at New PECO, Inc. 800-438-5823 or email Sales@lawnvac.com.

Section I - INTRODUCTION AND DESCRIPTION

Introduction

We are pleased to have you as a PECO customer. Your collection system has been designed to give you a low maintenance, simple, and effective way to collect the grass clippings from your mower. The manuals are provided to give you the necessary instructions to properly mount, operate and maintain the collection system on your mower. Please read this manual thoroughly. Understand what each control is for and how to use it. Observe all safety decal precautions on the machine and noted throughout the manual.

NOTE: All references made to right, left, front, rear, top or bottom are as viewed from the normal operator's position on the mower.

Description

The grass collection system is designed for turf maintenance where there is a need to collect the grass clippings as the mower cuts the turf. It is also used for picking up leaves in pre-season and post-season clean-up. The blower, mounted on the right side of the unit, uses a belt and gearbox system from the engine PTO shaft. Drive train protection comes through belt slippage. The blower draws grass clippings from the discharge area of the cutting deck back to the collection bags at the rear portion of the mower frame. The operator can engage the blower with a push of the over-center linkage on the right side of the unit. Once the bags are full with clippings, they can be easily released for dumping.

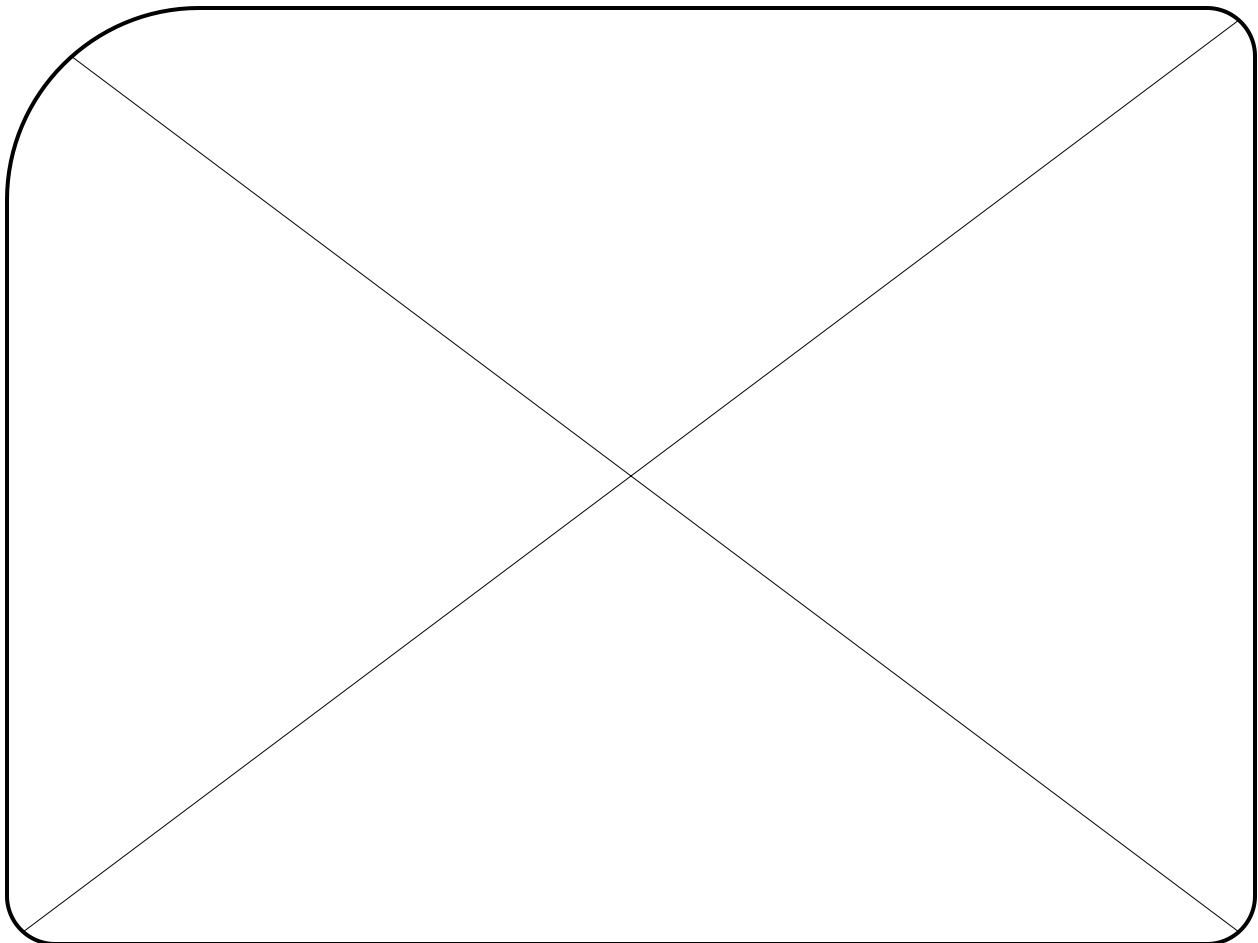

Section II - INSTALLATION FOR USE

Preparation Of Mower

NOTE: The mower deck PTO belt must be removed from the electric clutch before continuing with the installation. Refer to your mower's owner's manual for instructions on PTO belt removal.

From the underside of the engine, disconnect the wiring harness attached to the electric clutch. Remove the bolt and electric clutch from the mower. Refer to Figure A.

Figure A

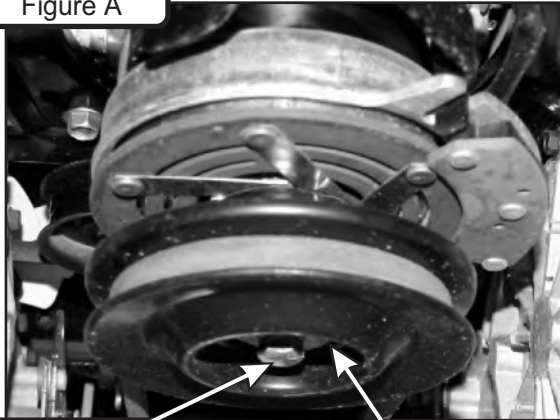

Remove Bolt

D-Drive Spacer

Upon removal of clutch determine if your mower is equipped with a D-drive spacer. If so, then proceed to Figure B. If your mower is equipped with bolt, fender and lock washer without D-drive spacer proceed to Figure C. Remove the D-drive spacer using an arbor press or equivalent. On removal, adjacent bearing OUTER race must be supported or bearing damage may occur. Refer to Figure B.

Figure B

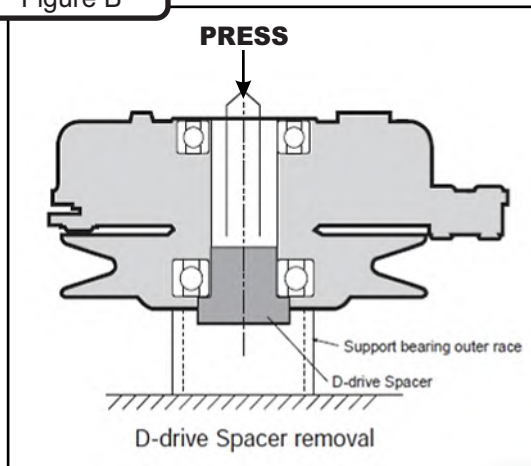
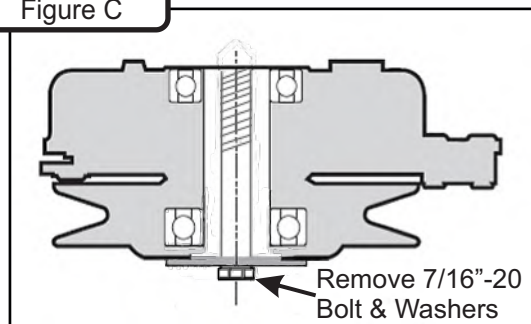
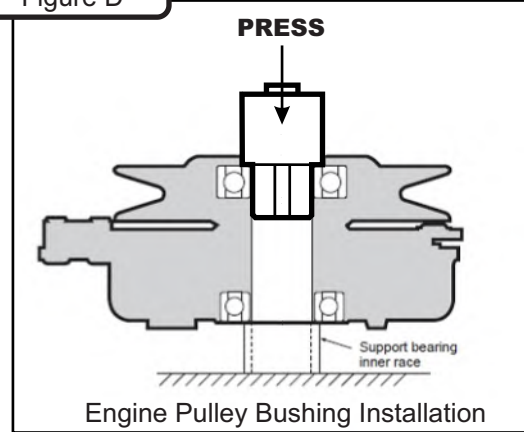

Figure C



The engine pulley assembly must be installed using an arbor press or equivalent. During installation, opposite bearing inner race must be supported or bearing damage may occur. Refer to Figure D.

Figure D



Once the Engine Pulley Bushing is installed, reattach the clutch assembly & deck PTO belt to the mower and then review Figure E.

Figure E

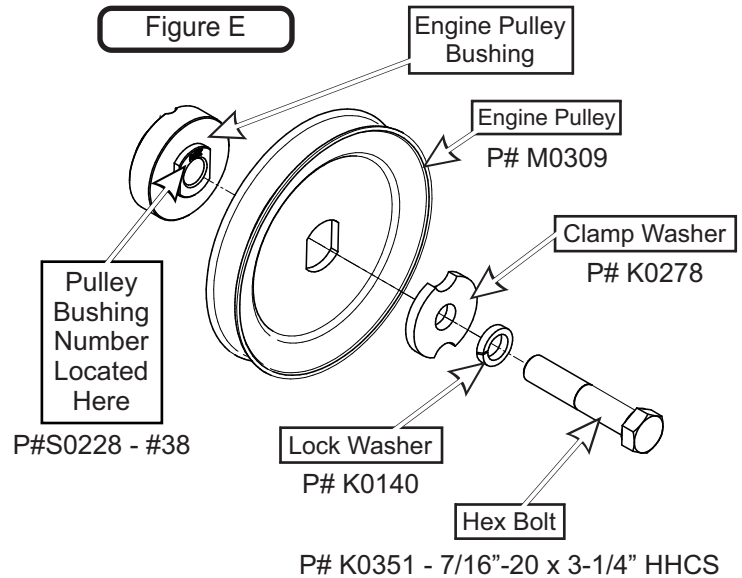

To assemble and fasten the Engine Pulley, align the Engine Pulley Bushing to the mower's clutch pulley and fasten using (1) Clamp Washer, (1) Lock Washer, and (1) Hex Bolt. Torque the bolt to 55 ft./lbs. The added pulley will power the collection system and should resemble Figure F when installed.

Figure F

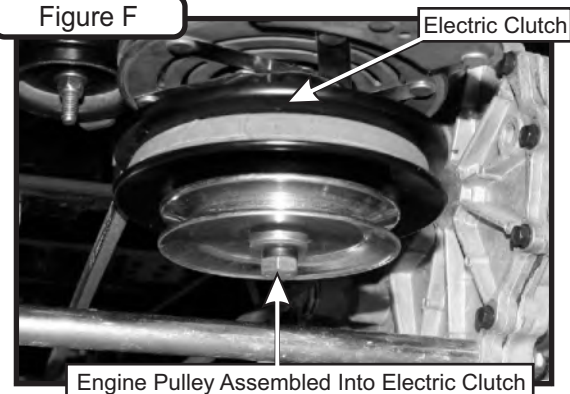

Parking Brake Cable Mount

To ensure proper clearance for the PTO belt it is recommended to remove and flip the parking brake cable mount resecuring it with the original hardware as shown. Test parking brake afterward to ensure proper functionality and free movement.

See Figure A and B.

Figure A



Figure B



Top Side Frame Bracket Installation

Before the installation of the Top Side Frame Brackets, locate and remove the hardware used to secure the lower part of the ROPS to the mower, refer to Figure A. It is recommended to work and install on one side first before moving onto the other side.

Note: Some parts and part features have been hidden from view for visual clarity.

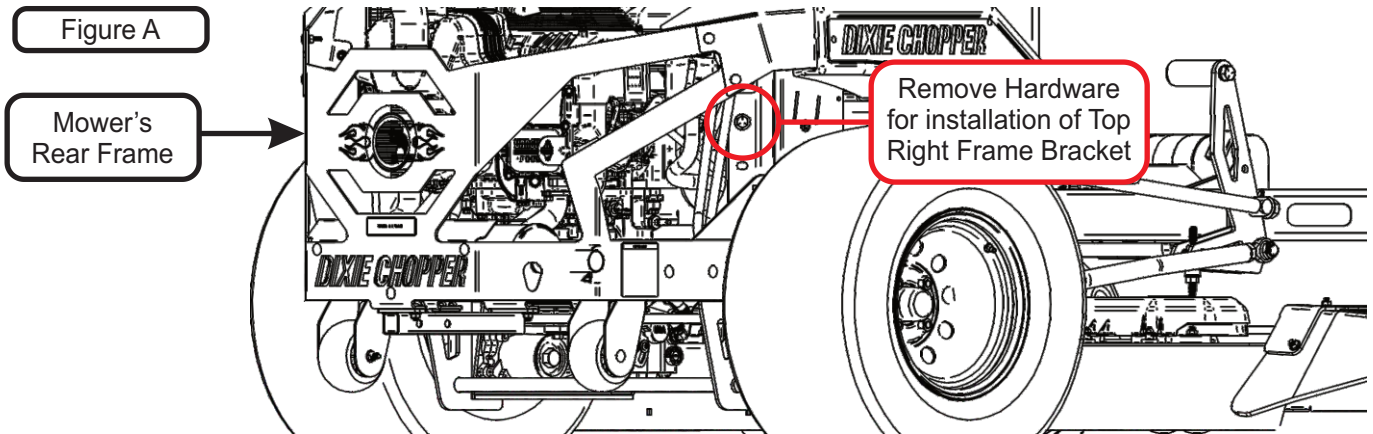

Place and position the Top Frame Bracket / Right (Item #1) in between the mower's rear frame and align the bolt holes of the Top Frame Bracket / Right to the ROPS bolt holes. Refer to the Figures below.

Secure the Top Frame Bracket / Right to the mower relatively loose by using (2) 1/2"-13 x 3-1/2" GR5 HHCS (Item #2), (2) 1/2" Flat Washers (Item #3) and (2) 1/2"-13 Flange Nuts (Item #4). Refer to Figure A.

Repeat the procedure for the opposite side. Keep the hardware relatively loose until after the installation on pg 12.

Figure B

| Item # | Part # | Desc. | Qty. |
|--------|--------|--|------|
| 1 | B2595 | Top Frame Bracket / Right | 1 |
| 2 | K1237 | 1/2"-13 x 3-1/2" HHCS GR5 | 2 |
| 3 | K0055 | Flat Washer 1/2" / 1.383 OD x .560 ID x .120 T | 2 |
| 4 | K1246 | Flange Nut 1/2"-13 | 2 |

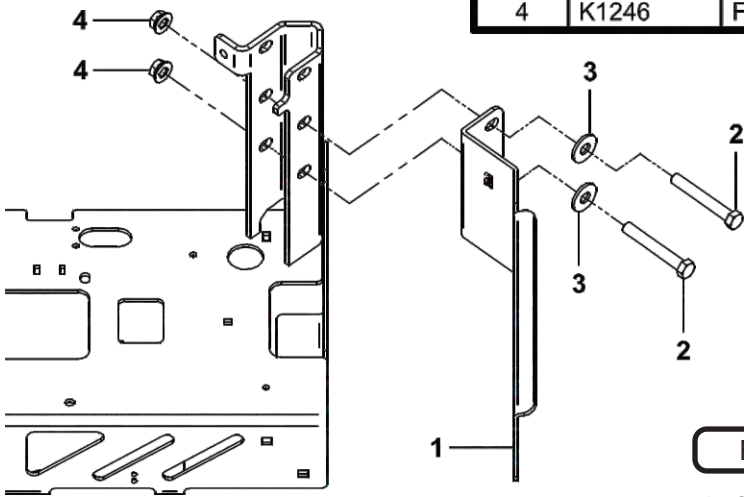
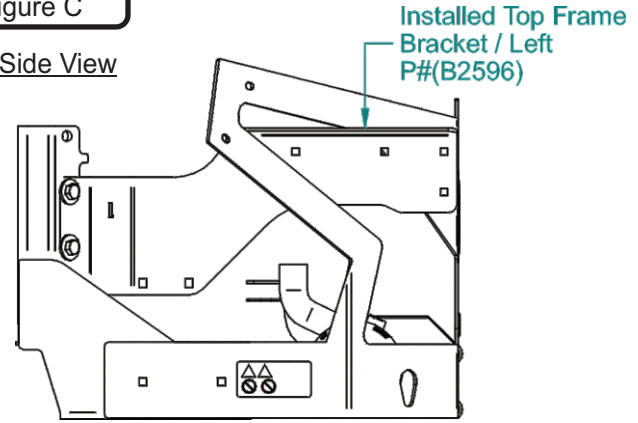

Figure C

Left Side View



Side Frame Bracket Installation

Before the installation of the Side Frame Brackets, locate and remove the (2) set of hardware used to secure the lower part of the mower's rear frame, refer to Figure A. It is recommended to work and install on one side first before moving onto the other side. It is also recommended to remove the right rear roller and roller mount bracket for clearance of the PTO Installation. See Figure A.

Note: Some parts and part features have been hidden from view for visual clarity.

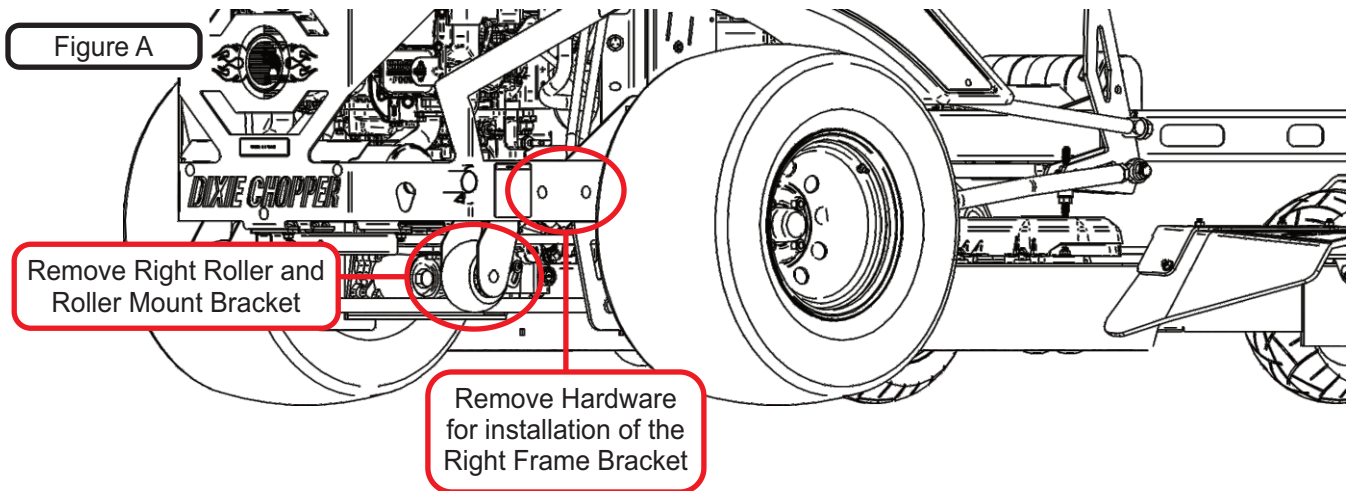

Position the Top PTO Mount Bracket (Item #3) to the Right Frame Bracket (Item #2) aligning the row of carriage bolt holes between the two parts and secure using (2) 3/8"-16 x 1-1/4" HHCS (Item #6), (1) 3/8"-16 x 1" HHCS (Item #8) and (3) 3/8"-16 Flange Nuts (Item #7). Note orientation and position of each bolt. Refer to Figure B.

Next position the Lower PTO Mount Bracket (Item #4) to the Right Frame Bracket (Item #2) aligning the row of carriage bolt holes between the two parts and secure using (2) 3/8"-16 x 1-1/2" Carriage Bolts (Item #5), and (2) 3/8"-16 Ny-Flange Lock Nuts (Item #7). Refer to Figure below.

Keep the hardware relatively loose until after the installation on pg 12.

Note: Some parts and part features have been hidden from view for visual clarity.

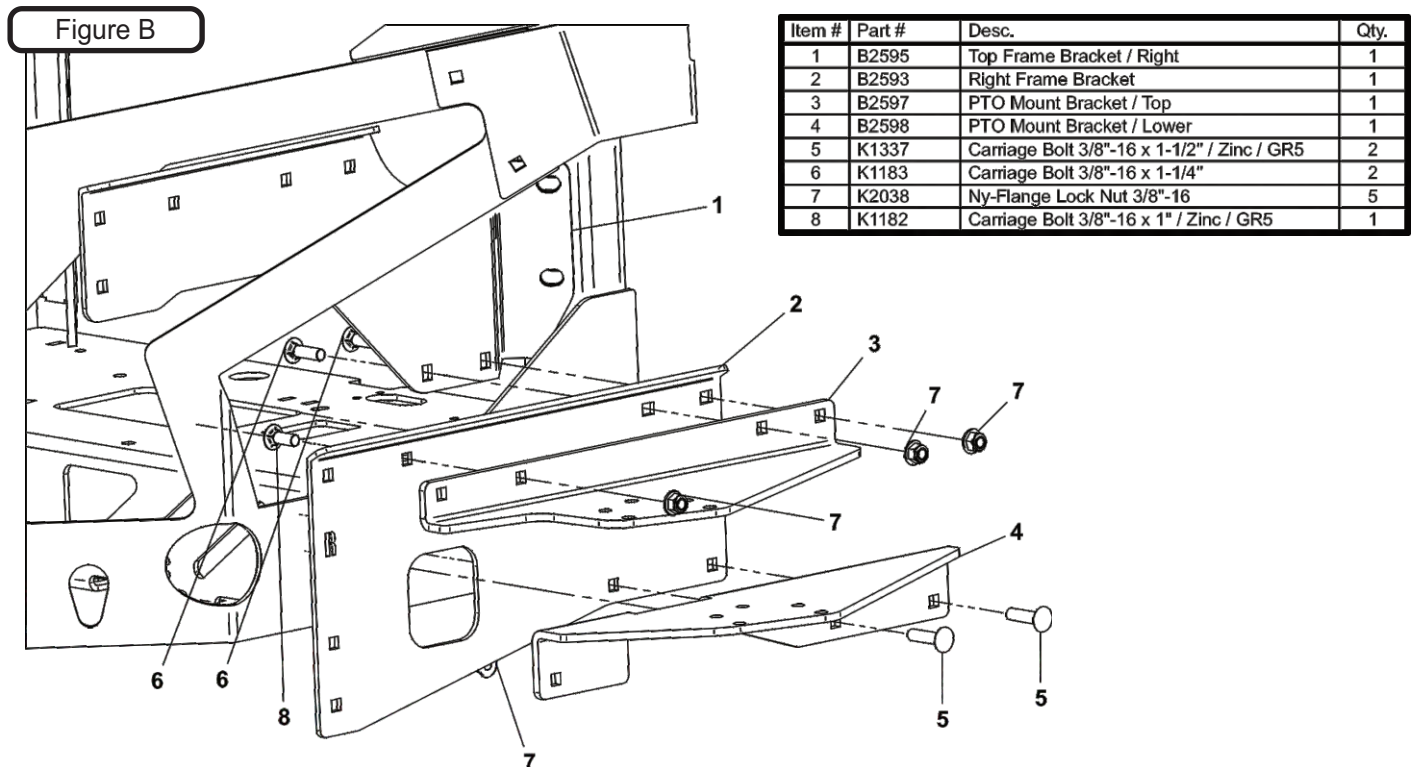

Side Frame Bracket Installation Cont.

To secure the Left Frame Bracket (Item #2) to the mower's rear lower Left side frame use (2) 3/8"-16 x 1-1/4" HHCS (Item #3) and (2) 3/8"-16 Flange Nuts (Item #5). Refer to Figure A.

To secure the Left Bracket to the Top Frame Bracket / Left (Item #1) use (2) 3/8"-16 x 1" HHCS (Item #4) and (2) 3/8"-16 Flange Nuts (Item #5). Refer to Figure A.

Keep the hardware relatively loose until after the installation on pg 12.

Figure A

| Item # | Part # | Desc. | Qty. |
|--------|--------|---|------|
| 1 | B2596 | Top Frame Bracket / Left | 1 |
| 2 | B2594 | Left Frame Bracket | 1 |
| 3 | K1183 | Carriage Bolt 3/8"-16 x 1-1/4" | 2 |
| 4 | K1182 | Carriage Bolt 3/8"-16 x 1" / Zinc / GR5 | 2 |
| 5 | K2038 | Ny-Flange Lock Nut 3/8"-16 | 4 |

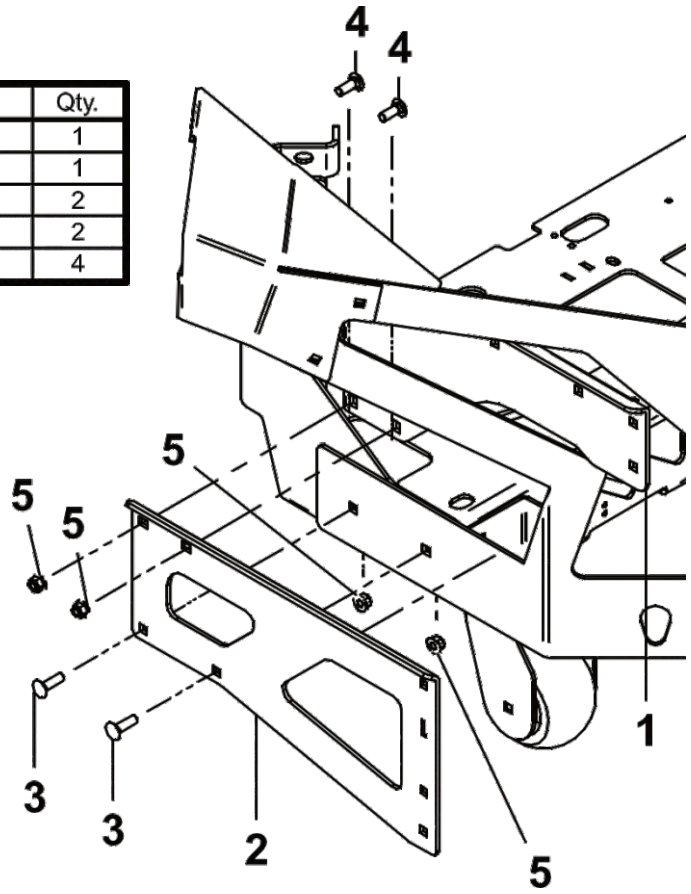

Main Frame Bracket Installation

Secure the Main Frame Bracket (Item #1) to the Left Frame Bracket (Item #2) and Top Frame Bracket / Left (Item #3) by using (5) 3/8"-16 x 1" Carriage Bolts (Item #4) and (5) 3/8"-16 Ny-Flange Lock Nuts (Item #5). Refer to Figure A.

Keep the hardware relatively loose until after the installation on pg 12.

Figure A

| Item # | Part # | Desc. | Qty. |
|--------|--------|---|------|
| 1 | B2592 | Main Frame Bracket | 1 |
| 2 | B2596 | Top Frame Bracket / Left | 1 |
| 3 | B2594 | Left Frame Bracket | 1 |
| 4 | K1182 | Carriage Bolt 3/8"-16 x 1" / Zinc / GR5 | 5 |
| 5 | K2038 | Ny-Flange Lock Nut 3/8"-16 | 5 |

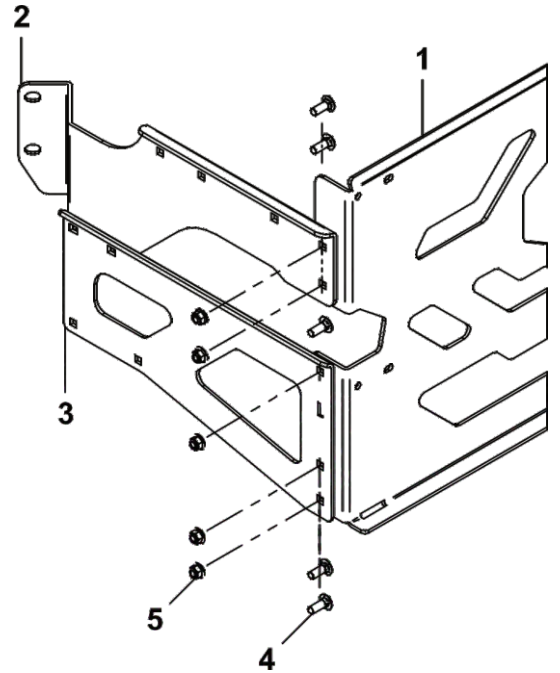

Secure the Main Frame Bracket (Item #1) to the Right Frame Bracket (Item #4) and Top Frame Bracket / Right (Item #2) by using (3) 3/8"-16 x 1" Carriage Bolts (Item #7), (2) 3/8"-16 x 1-1/4" Carriage Bolts (Item #6) and (5) 3/8"-16 Ny-Flange Lock Nuts (Item #8). Refer to Figure B.

Keep the hardware relatively loose until after the installation on pg 12.

Figure B

| Item # | Part # | Desc. | Qty. |
|--------|--------|---|------|
| 1 | B2592 | Main Frame Bracket | 1 |
| 2 | B2595 | Top Frame Bracket / Right | 1 |
| 3 | B2593 | Right Frame Bracket | 1 |
| 4 | B2598 | PTO Mount Bracket / Lower | 1 |
| 5 | B2597 | PTO Mount Bracket / Top | 1 |
| 6 | K1183 | Carriage Bolt 3/8"-16 x 1-1/4" | 2 |
| 7 | K1182 | Carriage Bolt 3/8"-16 x 1" / Zinc / GR5 | 3 |
| 8 | K2038 | Ny-Flange Lock Nut 3/8"-16 | 5 |

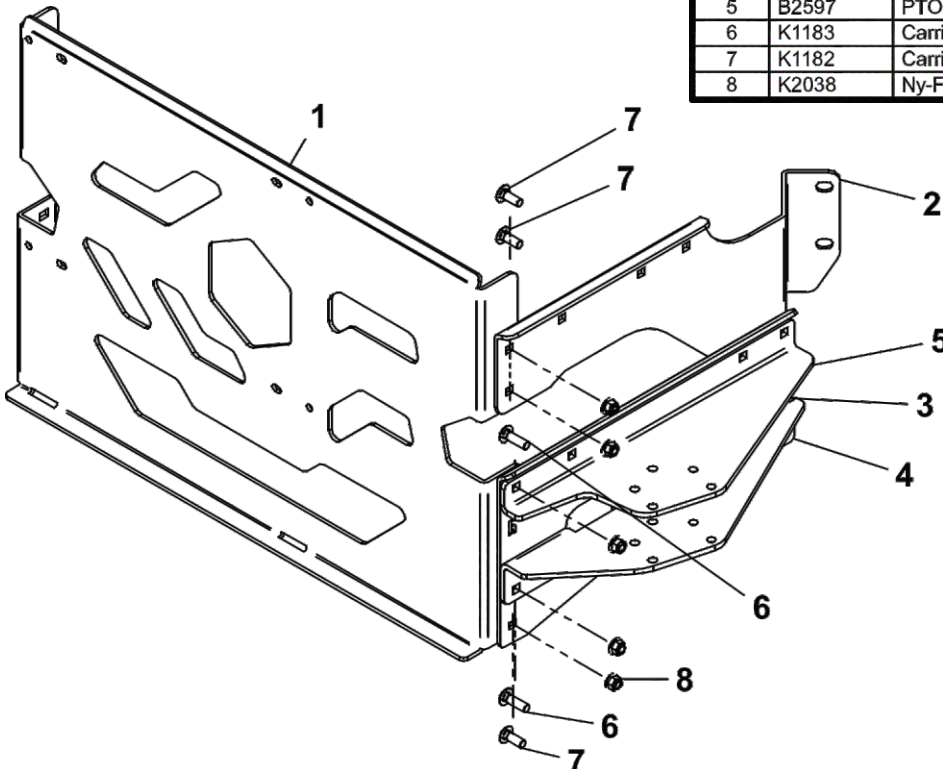

Mount Arm / Receiver Tube Assembly & Exhaust Shield / Top Installation

First, place (5) Grade 5 3/8"-16 x 3-3/4" HHCS (Item #3) into the bolt holes of both the Top & Lower Mount Brackets, refer to Figure A. Then, position and place the Receiver Tube Assy / Mount Arm (Item #1) between the Mount Brackets and bolts. Next, align and position the Exhaust Shield / Top (Item #2) under the Lower PTO Mount Bracket as shown in Figure A. Finally, secure the Receiver Tube Assy / Mount Arm & Exhaust Shield / Top by fastening (5) 3/8"-16 Ny-flange Lock Nuts (Item #4) to the (5) Grade 5 3/8"-16 x 3-3/4" HHCS (Item #3). Refer to Figure A.

Tighten all hardware at this time

Note: Some parts and part features have been hidden from view for visual clarity.

| Item # | Part # | Desc. | Qty. |
|--------|--------|---------------------------------|------|
| 1 | A2207 | Receiver Tube Assy. / Mount Arm | 1 |
| 2 | C0124 | Exhaust Shield / Top | 1 |
| 3 | K1012 | 3/8"-16 x 3.75" HHCS G5 | 5 |
| 4 | K2038 | Ny-Flange Lock Nut 3/8"-16 | 5 |

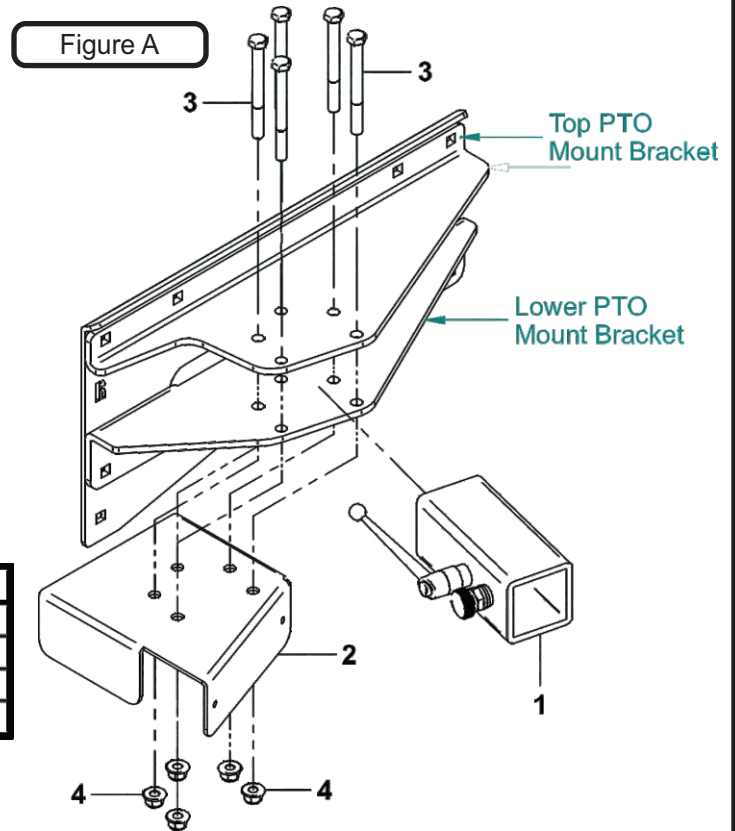

Exhaust Shield / Bottom Installation

Position the Exhaust Shield / Bottom (Item #2) below and over the Exhaust Shield / Top (Item #1) as shown in Figure B. Align the bolt holes of the Top & Bottom Exhaust Shields and secure them together by using (4) 1/4"-20 x 1/2" Thread Cutting Screws (Item #3). Refer to Figure B.

Note: Some parts and part features have been hidden from view for visual clarity.

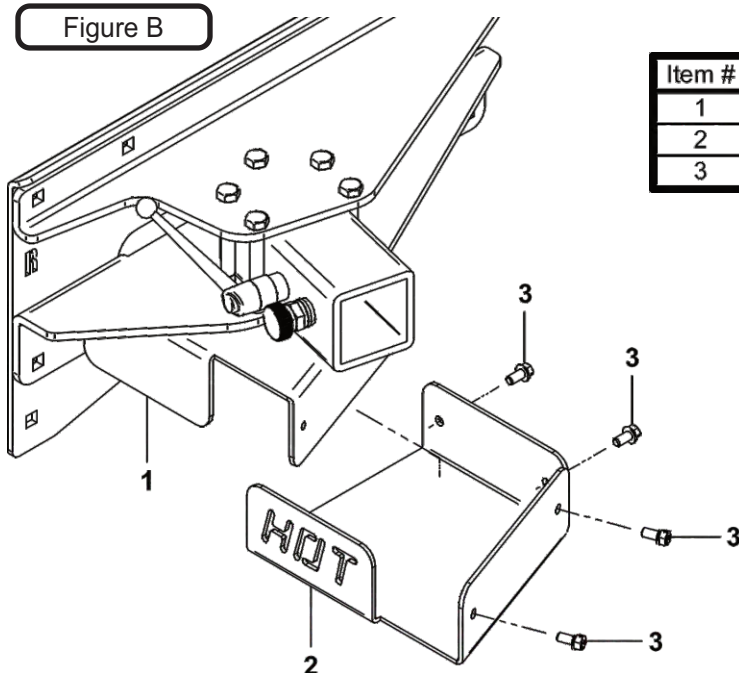

| Item # | Part # | Desc. | Qty. |
|--------|--------|-------------------------|------|
| 1 | C0124 | Exhaust Shield / Top | 1 |
| 2 | C0125 | Exhaust Shield / Bottom | 1 |
| 3 | K0353 | HWHTCS 1/4"-20 x 1/2" | 4 |

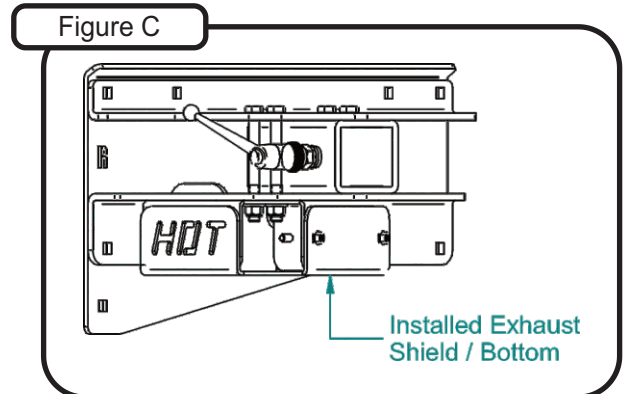

Main Frame Leg Installation

Position the Main Frame Leg / Right (Item #4) over the mower's rear frame and behind the Top Frame Bracket / Right (Item #3), refer to Figure B. Align the bolt holes and secure the Main Frame Leg / Right by using (3) 3/8"-16 x 1" Carriage Bolts (Item #6) and (3) 3/8"-16 Ny-Flange Lock Nuts (Item #7), refer to Figure A.

Repeat the procedure for the installation of the Main Frame Leg / Left (Item #5). Keep the hardware relatively loose until after the installation of the Main Frame Assembly on pg 14.

Note: Some parts and part features have been hidden from view for visual clarity.

Figure A

| Item # | Part # | Desc. | Qty. |
|--------|--------|---|------|
| 1 | B2592 | Main Frame Bracket | 1 |
| 2 | B2596 | Top Frame Bracket / Left | 1 |
| 3 | B2595 | Top Frame Bracket / Right | 1 |
| 4 | B2599 | Main Frame Leg / Right | 1 |
| 5 | B2600 | Main Frame Leg / Left | 1 |
| 6 | K1182 | Carriage Bolt 3/8"-16 x 1" / Zinc / GR5 | 3 |
| 7 | K2038 | Ny-Flange Lock Nut 3/8"-16 | 3 |

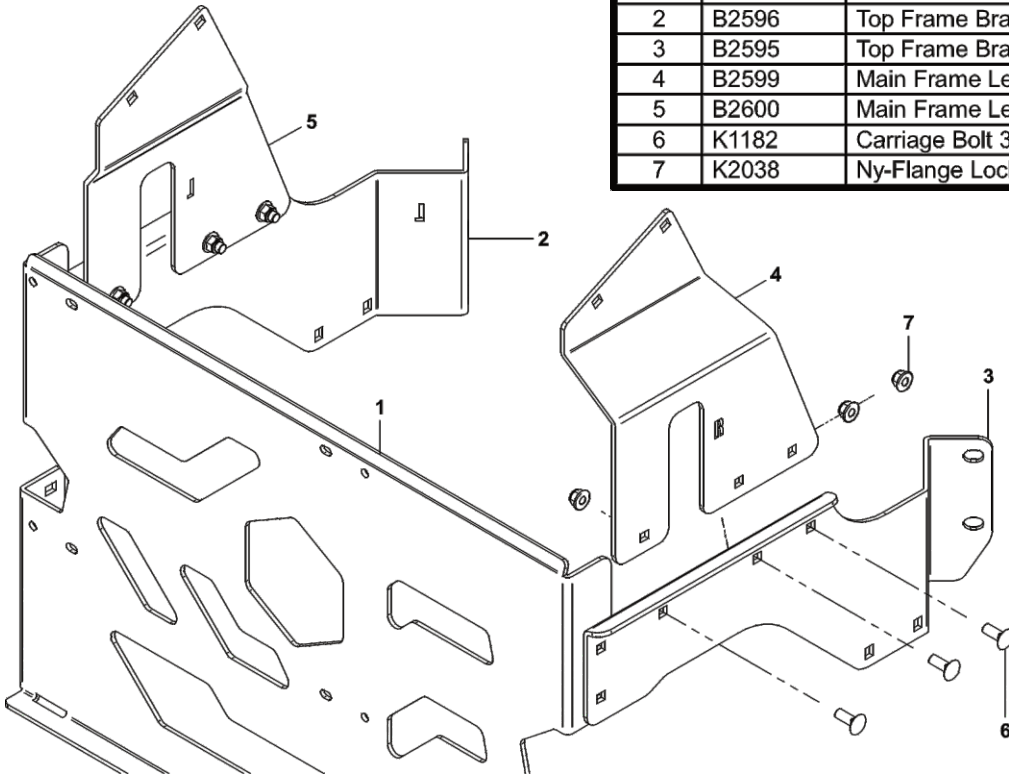
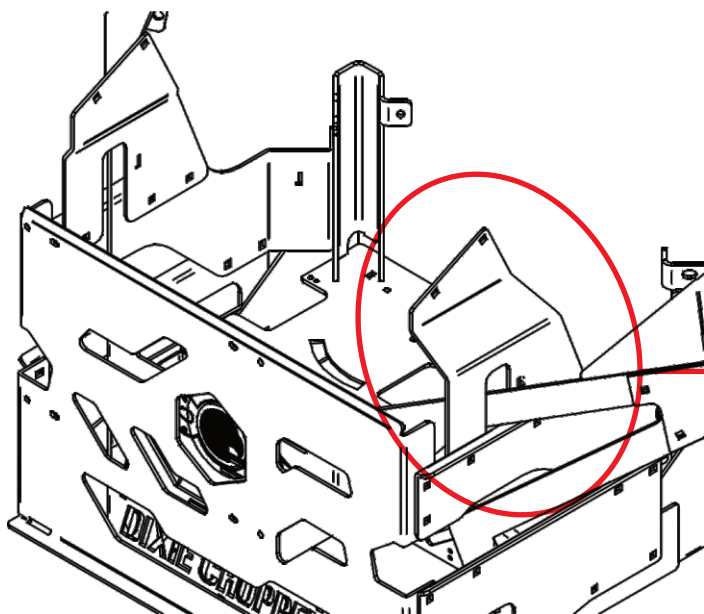

Figure B



Position Main Frame Leg
Over Mower's Rear Frame
& Behind the Top Frame
Bracket

Main Frame Assembly Installation

Align the bolt holes of the Main Frame Assembly (Item #1) to those on the Right Main Frame Leg (Item #2) and Left Main Frame Leg (Item #3). Be sure the Main Frame Assembly is sitting on the inside of both Main Frame Mounts.

Secure the Main Frame Assembly by using (2) 3/8"-16 x 1" Carriage Bolts (Item #4) and (2) 3/8"-16 Ny-Flange Lock Nuts (Item #5) PER side. Refer to the Figure below.

Tighten all hardware at this time.

Note: Some parts and part features have been hidden from view for visual clarity.

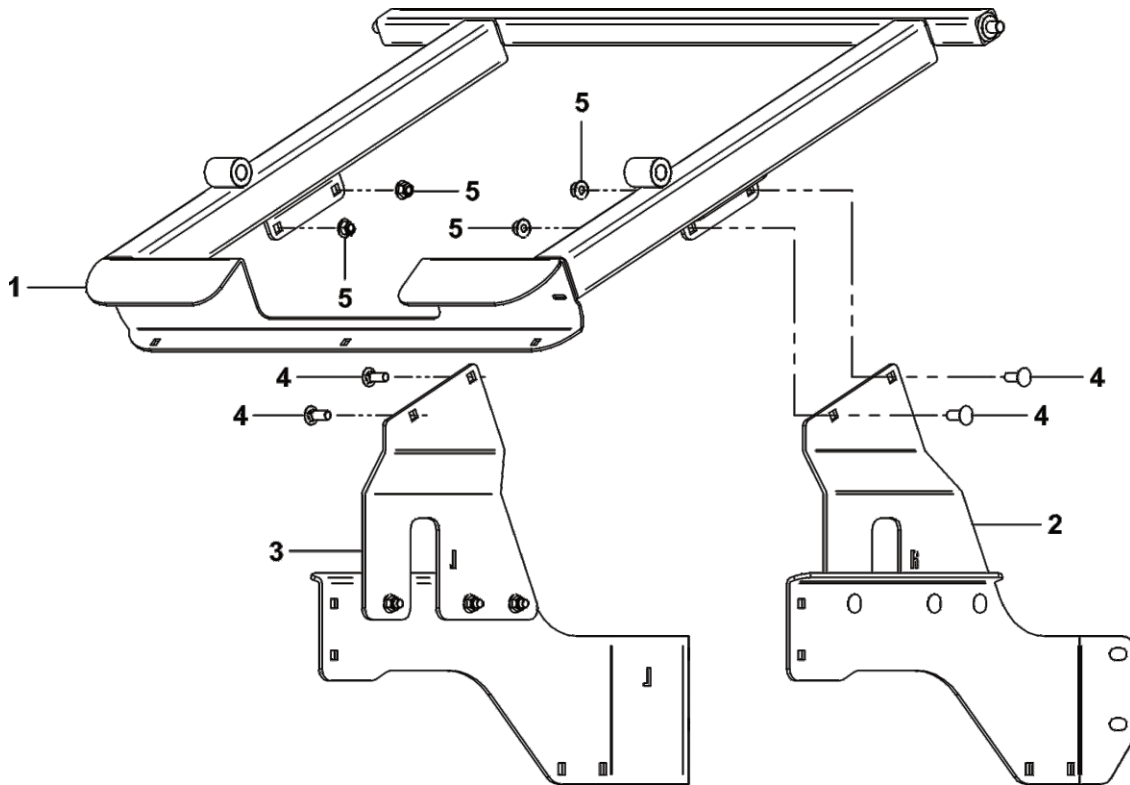

| Item # | Part # | Desc. | Qty. |
|--------|--------|---|------|
| 1 | A1192 | Main Frame Assembly | 1 |
| 2 | B2599 | Main Frame Leg / Right | 1 |
| 3 | B2600 | Main Frame Leg / Left | 1 |
| 4 | K1182 | Carriage Bolt 3/8"-16 x 1" / Zinc / GR5 | 4 |
| 5 | K2038 | Ny-Flange Lock Nut 3/8"-16 | 4 |

PTO Drive Assembly

Once the Mount Arm Assembly is installed and secured to the mower, assemble the Drive Assembly P#(A2061_02), Belt Guard Assembly P#(A2069_02) & Idler Mount Assembly P#(A2067_02).

First, attach the Belt Guard Assembly P#(A2069_02) to the Drive Assembly P#(A2061_03) using (2) 1/4"-20 x 5/8" Carriage Bolts P#(K1010) and (2) 1/4"-20 Ny-Flange Lock Nuts P#(K2014). Refer to Figure A. **Leave Bolts Loose.**

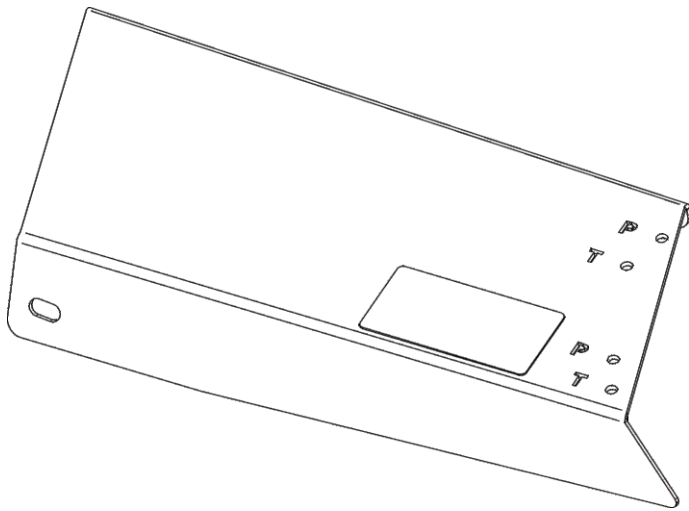

BELT GUARD ASSY. HOLES

Notice Marked Holes Below;
For This Installation, Use Holes
Marked With The Letter 'P'

Figure A

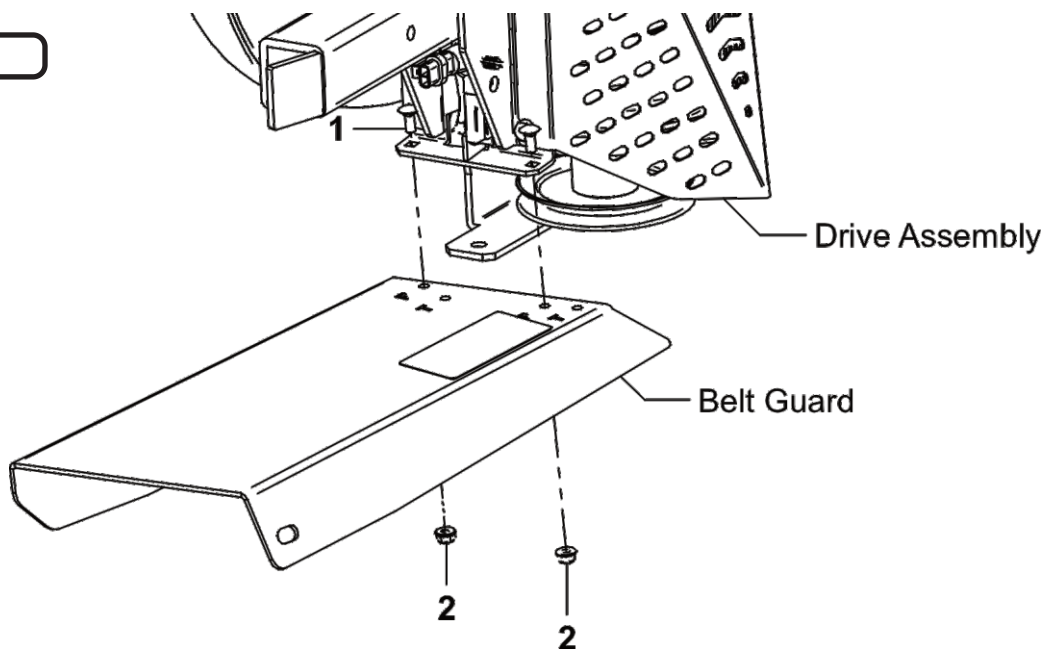

| Item # | Part # | Desc. | Qty. |
|--------|--------|------------------------------|------|
| 1 | K1010 | 1/4"-20 x 5/8" Carriage Bolt | 2 |
| 2 | K2014 | 1/4"-20 Ny-Flange Lock Nut | 2 |

PTO Drive Assembly (Continued)

Attach the Idler Mount Assembly P#(A2067_02) to the Drive Assembly using (1) 3/8"-16 x 1" HHCS (A) (Item #1), (1) 3/8"-16 x 1" Carriage Bolt (B) (Item #2) and (2) 3/8"-16 Ny-Flange Lock Nuts (Item #3). Refer to Figure B.

Leave Bolts Loose (Note: Orientation of bolts A & B.)

Next, secure the Idler Mount Assembly P#(A2067_02) to the Belt Guard Assembly P#(A2069_02) using (2) 3/8"-16 x 1" Carriage Bolts (Item #2) and (2) 3/8"-16 Ny-Flange Lock Nuts (Item #3). Refer to Figures C & D. Tighten All Bolts.

Figure B

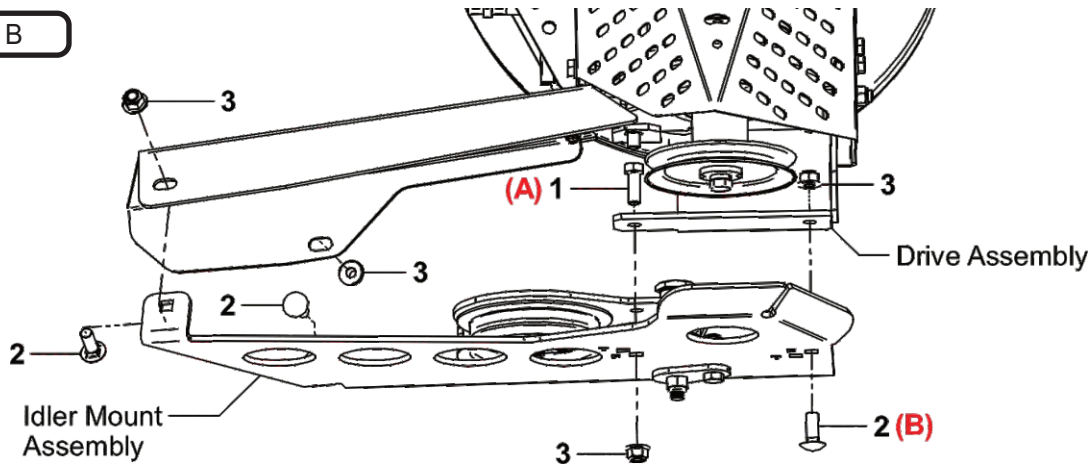

| Item # | Part # | Desc. | Qty. |
|--------|--------|----------------------------|------|
| 1 | K1191 | HHCS 3/8"-16 x 1" GR5 | 1 |
| 2 | K1182 | Carriage Bolt 3/8"-16 x 1" | 3 |
| 3 | K2038 | Ny-Flange Lock Nut 3/8"-16 | 4 |

Figure C

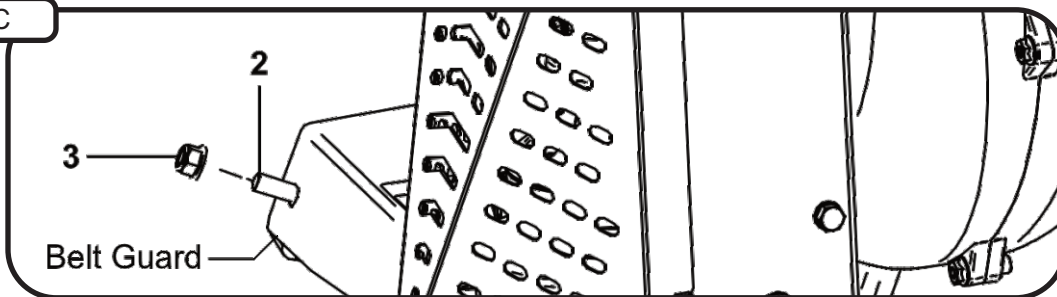
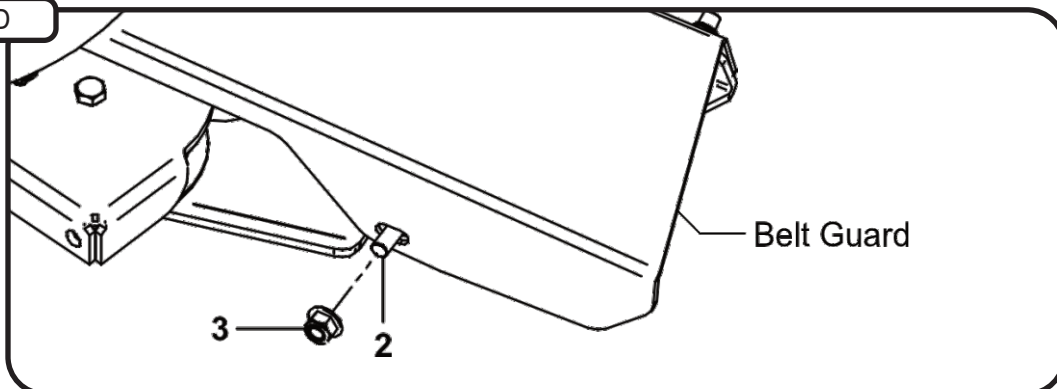

Figure D



Drive Assembly and Belt Installation

(Note: It is recommended that someone assist during this step.)

Insert the Drive Assembly into the receiver tube on the Mount Arm Assembly until the Knob Plunger Pin engages. Once in place, turn Lock Handle clockwise until tight. Next, feed the AK83 Belt P#(M0315) between the Belt Guard and the Idler Mount Assembly. Place belt around the Engine Drive Pulley on the underside of the mower. While one person inserts a screw driver (or similar tool) into the Idler Mount Assembly and rotates lever arm clockwise, enough to relieve all tension from belt, place belt around the Drive Assembly Pulley. Once the belt is in position, carefully release the tension to tighten belt.

Refer to the images below.

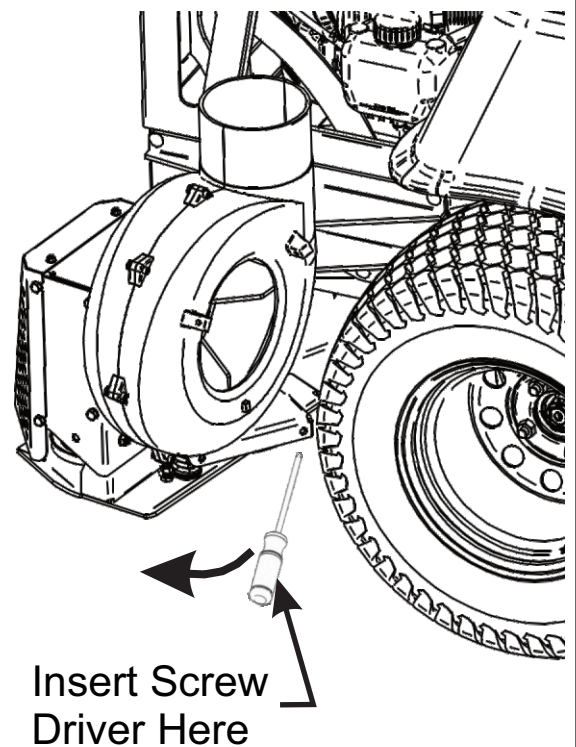
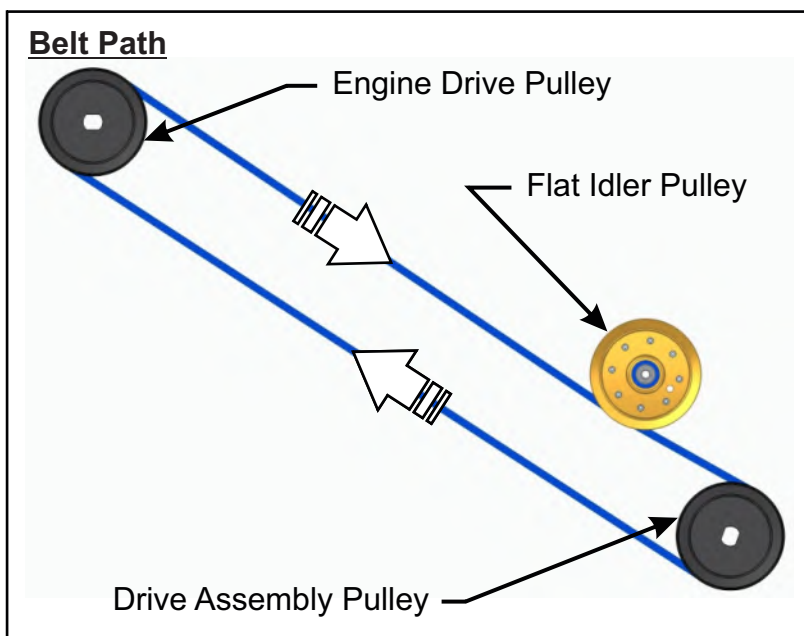
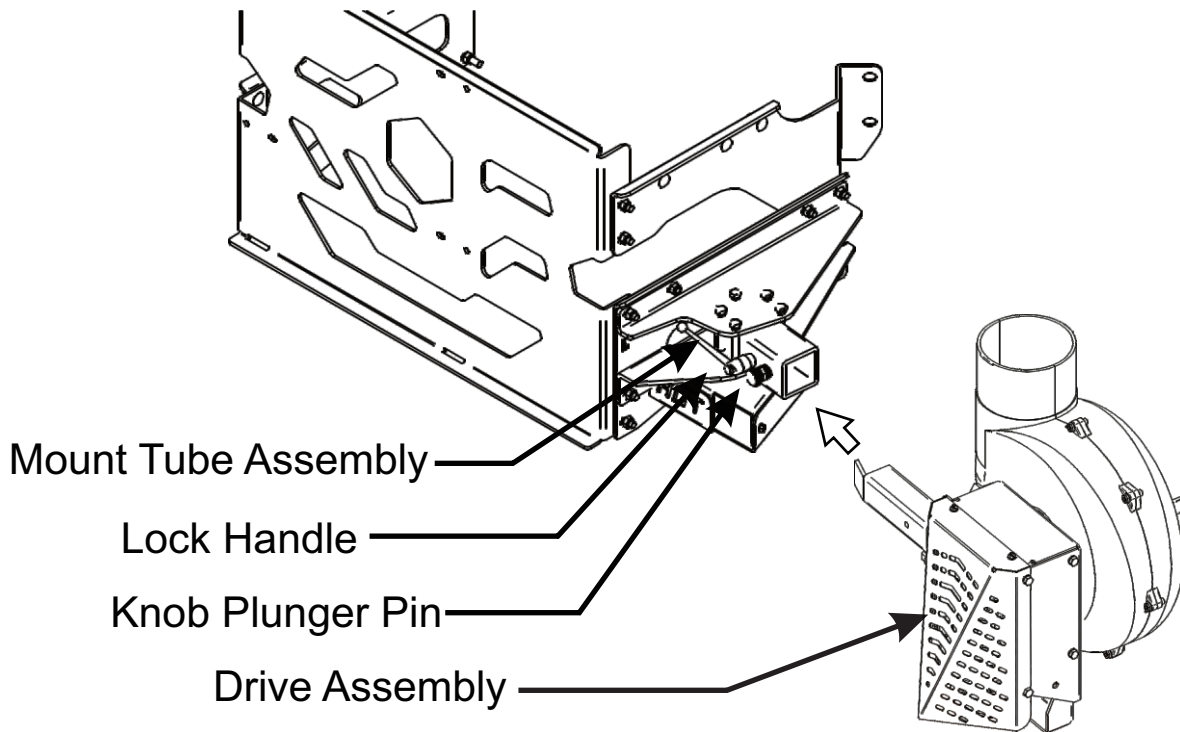

Boot Kit Installation

First, remove the mower's Operator Controlled Discharge Chute (OCDC) and attach the Boot Plate Adapter (Item #7) to the far right mounting hole as shown in Figure B using (1) 3/8"-16 x 1" Hex Head Cap Screw (Item #8), (1) 3/8" Flat Washer (Item #9) and (1) 3/8"-16 Ny-Flange Lock Nuts (Item #6).

Next, secure the Boot Plate (Item #2) to the Aluminum Boot (Item #1) using (2) 3/8"-16 x 1" Carriage Bolts (Item #5) and (2) 3/8"-16 Ny-Flange Lock Nuts (Item #6). Insert the Carriage Bolts from the inside of the Boot so the threads are on the top of the Boot. This will prevent grass clippings from collecting on the threads. Leave the hardware loose until the boot plate has been attached to the mower deck.

Then, align the Boot Plate Bushings to the Boot Plate Adapter Bushings. Insert the Boot Rod (Item #3) through the Boot Plate Adapter & Boot Plate Bushings.

Finally, secure the Boot Rod using a Hair Pin Clip (Item #4). With the Carriage Bolts (Item #5) still loose, adjust the position of the boot so that there is no gap between the mower deck and the boot. Once fully adjusted and positioned, tighten all hardware at this time.

Figure A

| Item # | Part # | Desc. | Qty. |
|--------|--------|---|------|
| 1 | E0044A | 8" Aluminum Boot / Modified E0030 | 1 |
| 2 | B0988 | Boot Plate | 1 |
| 3 | B0990 | Boot Plate Adapter | 1 |
| 4 | B0189 | Boot Rod | 1 |
| 5 | K1182 | Carriage Bolt 3/8"-16 x 1" / Zinc / GR5 | 2 |
| 6 | K2038 | Ny-Flange Lock Nut 3/8"-16 | 3 |
| 7 | K0047 | Flat Washer 3/8" / 1.00 OD x .446 ID x .075 T | 1 |
| 8 | K1191 | HHCS 3/8"-16 x 1" GR5 | 1 |
| 9 | K0099 | Hair Pin Clip 3/32" | 1 |

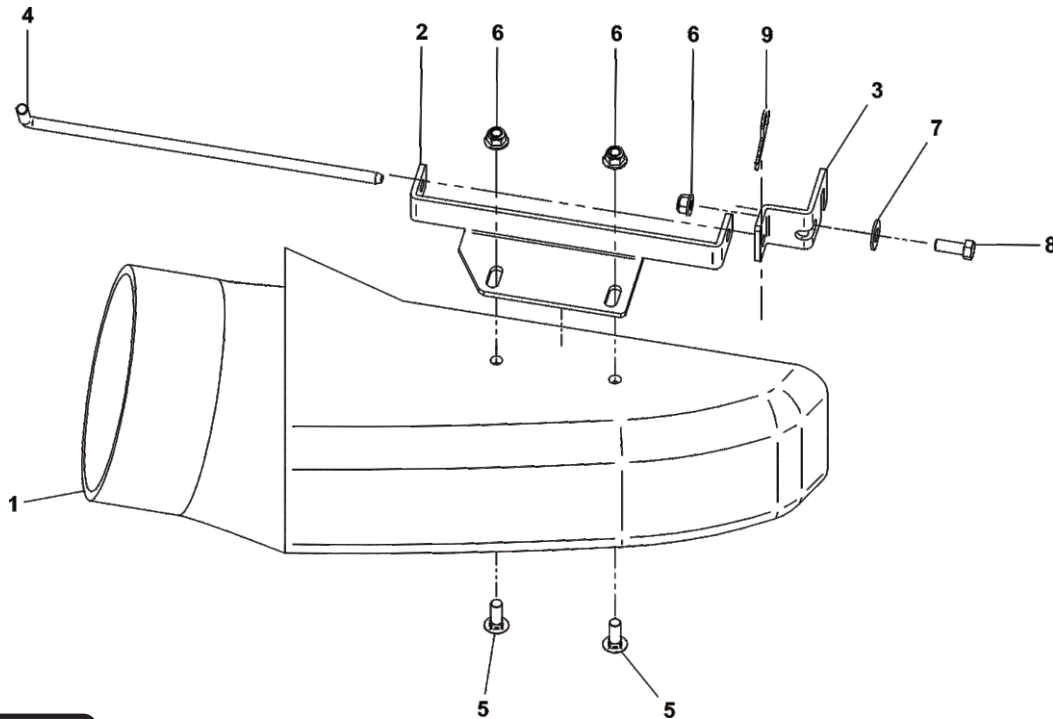
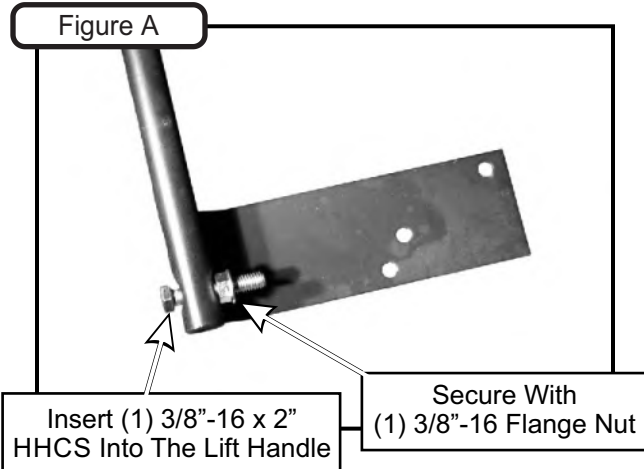

Figure B



Lift Handle Installation

NOTE: Before continuing the Lift Handle installation, have someone assist you in turning the Box Assembly upside down. Insert (1) 3/8"-16 x 2" HHCS P#(K1208) into the Lift Handle P#(A0897), and secure with (1) 3/8"-16 Flange Nut P#(K1215). Thread the flange nut onto the bolt upside down, as shown in Figure A. Do not tighten the nut fully at this time.



Slide the Lift Handle through the slot on the Handle Mount Bracket. Insert the Lift Handle into the Box Frame as shown in Figure B, and secure using (1) 3/8"-16 Flange Nut P#(K1215) on the inside of the Box as shown in Figure C. Now test the movement of the handle. It should have full-range of movement in the slot. If the handle does not have full-range of movement, adjust the 3/8"-16 Flange Nut from step A. Once achieved, tighten the fasteners.

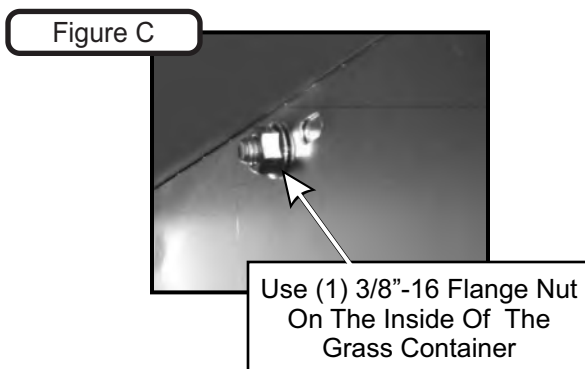
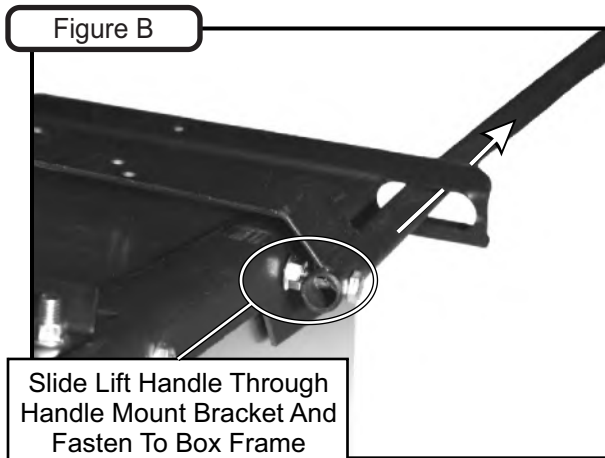

Fasten the Ball Joint P#(K1442) to the end of the Latch Rod P#(A2107). Tighten the Ball Joint to approximately half-way down the threads on the Latch Rod. Attach the Ball Joint to the Latch Hook as shown in Figure D, using (1) 5/16"-24 Hex Nut P#(K1444) and (1) 5/16" Lock Washer P#(K0043).

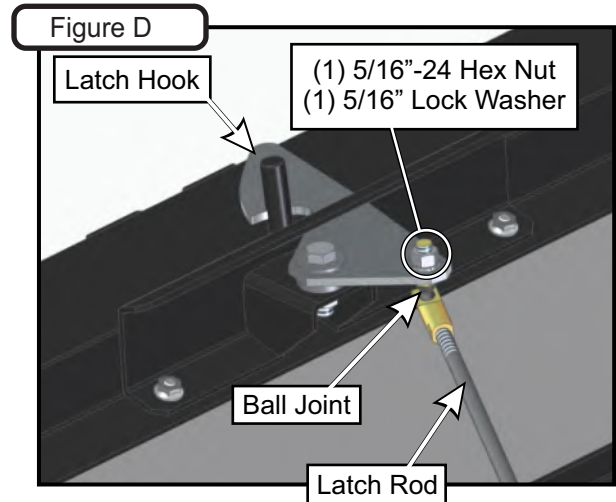

Attach the other end of the Latch Rod to the Lift Handle, as shown in Figure E. Attach one end of the Spring P#(J0176) to the Lift Handle and the other end of the Spring to the Handle Mount Bracket as shown in Figure F. Adjust the Ball Joint up or down on the Latch Rod threads until the Latch Hook closes completely. After adjusting the Latch Hook, secure the Latch Rod to the Lift Handle using (1) Cotter Pin P#(K0094).

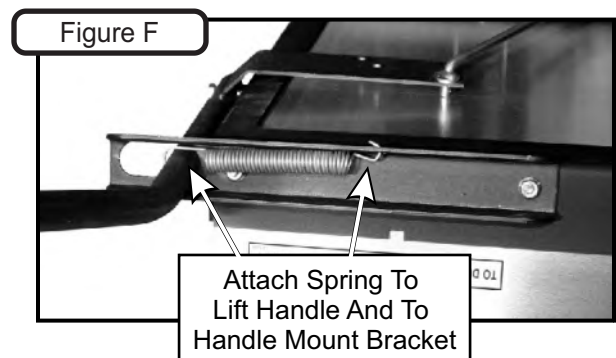
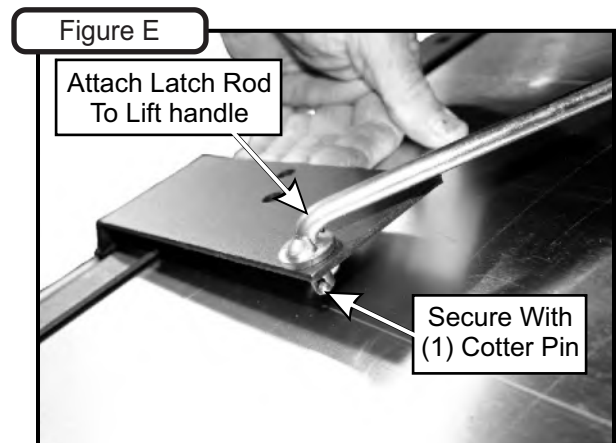

Aluminum Box Assembly Installation

NOTE: It is recommended that two extra people assist in mounting the Box Assembly.

Lower the Box Assembly onto the frame. Secure the Box Assembly by inserting the Pivot Pins P#(K0172) from the outside to the inside. Secure the Pins with (1) 5/8" Washer P#(K0058) and (1) 5/32" x 2-5/8" Hair Pin Clip P#(K0088) per Pivot Pin (Figure B).

Reattach the bottom ends of the door opening linkages to the Main Frame by using (1) Rue-Ring Cotter Pin P#(K1437) per side.

To test the functionality of the dump mechanism, pull the Lift Handle away from the unit, and lift upward. The Door of the Box Assembly should open and the Box should pivot back towards the ground.

Figure A

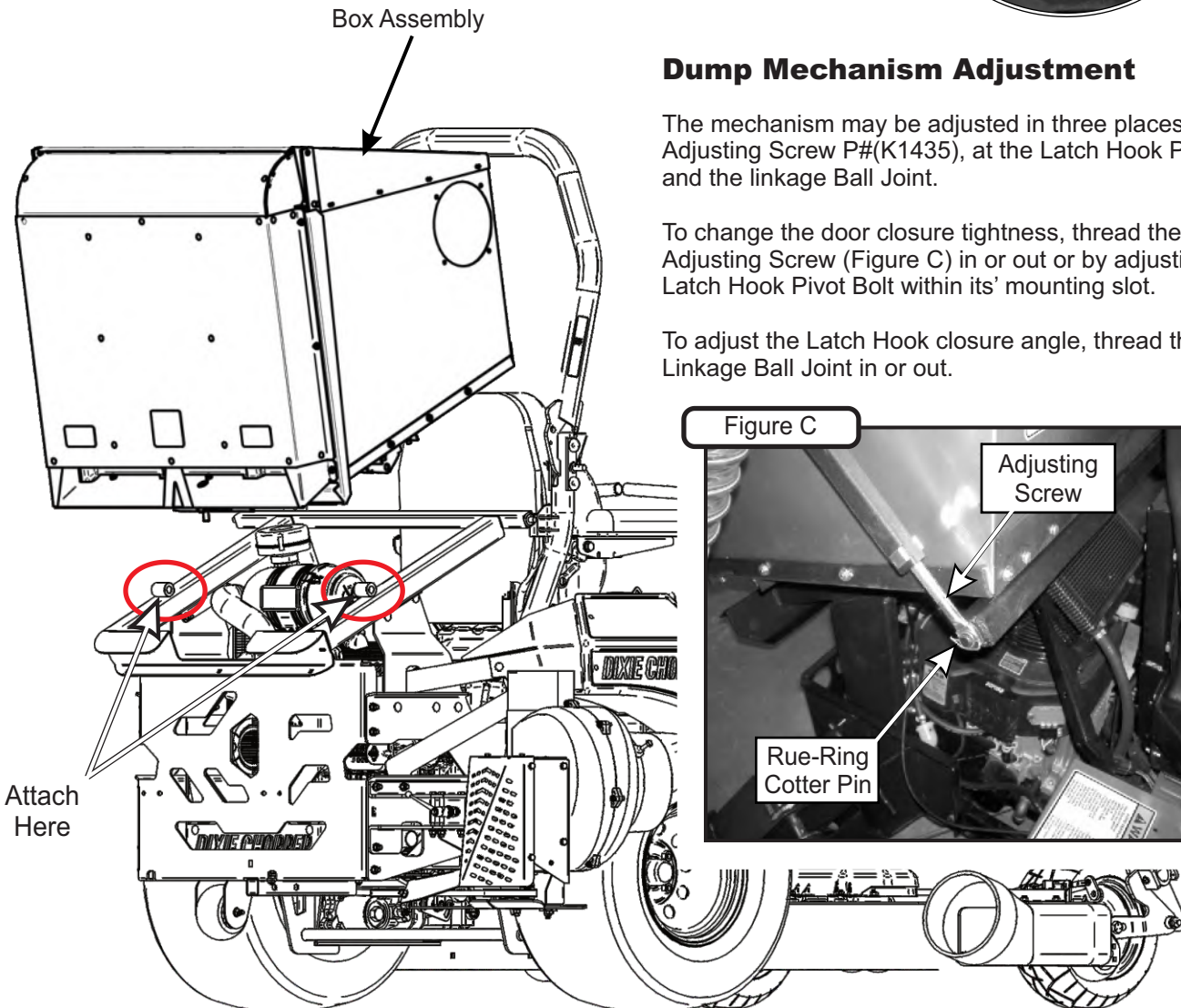
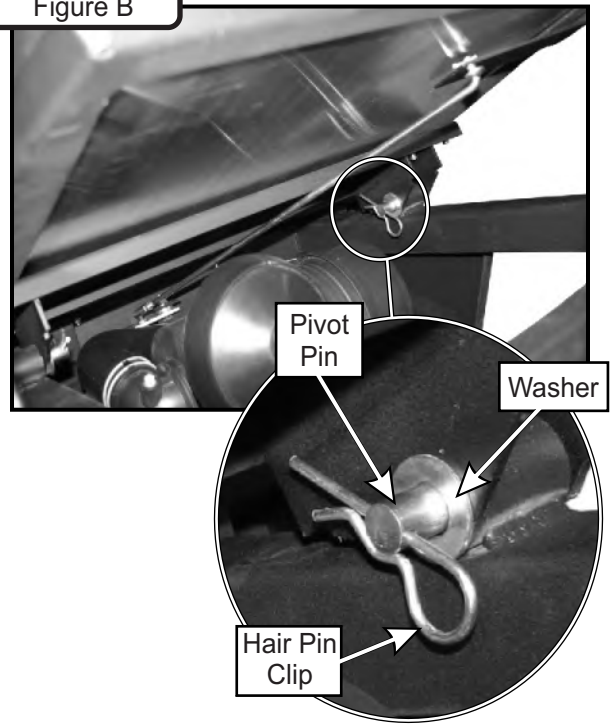

Figure B



Dump Mechanism Adjustment

The mechanism may be adjusted in three places, at the Adjusting Screw P#(K1435), at the Latch Hook Pivot Bolt and the linkage Ball Joint.

To change the door closure tightness, thread the Adjusting Screw (Figure C) in or out or by adjusting the Latch Hook Pivot Bolt within its' mounting slot.

To adjust the Latch Hook closure angle, thread the Linkage Ball Joint in or out.

Figure C

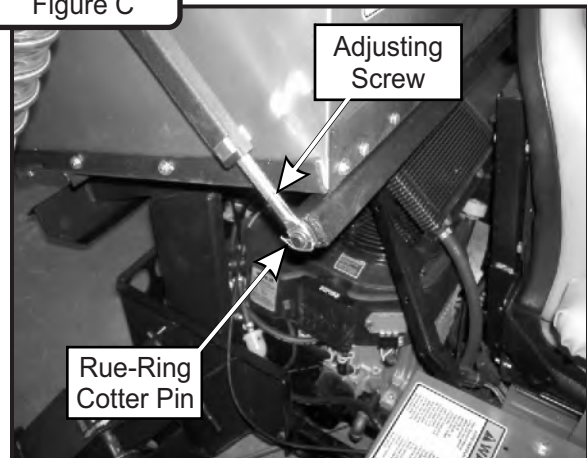

Inlet, Inlet Ring & Debris Deflector Installation

Open box door. From inside box, slide Inlet (Item #3) halfway into inlet hole (See Figure A). Take each half of the Inlet Ring (Item #1) and attach around matching groove in Inlet (Item #3). Slide Inlet (Item #3) & Inlet Ring (Item #1) against inlet hole and align four holes. Fasten Inlet Ring (Item #1) bottom holes using (2) 5/16" IT Tooth Lock Washers (Item #4) & (2) 5/16"-18 x 1/2" HHCS (Item #6) (See Figure B). Fasten Inlet Ring (Item #1) top holes using (2) 5/16" IT Tooth Lock Washers (Item #4) & (2) 5/16"-18 x 1-1/4" HHCS (Item #5). Slide Debris Deflector (Item #2) over inside top bolt threads (Item #5). Fasten Debris Deflector (Item #2) using (2) 5/16"-18 Ny-Flange Lock Nuts (Item #7). Final assembly should resemble Figure C.

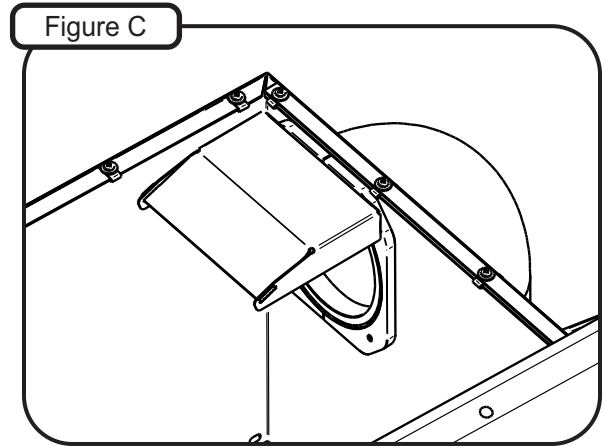
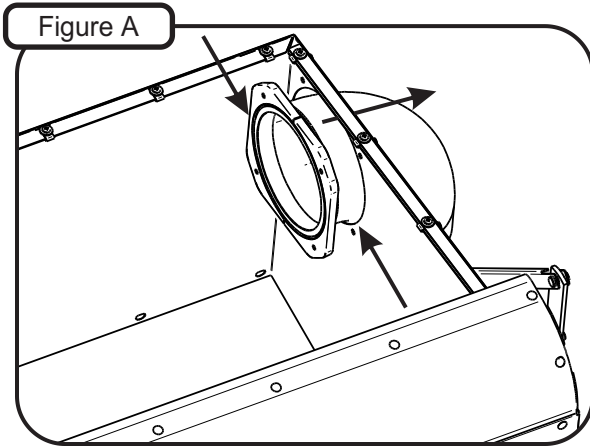
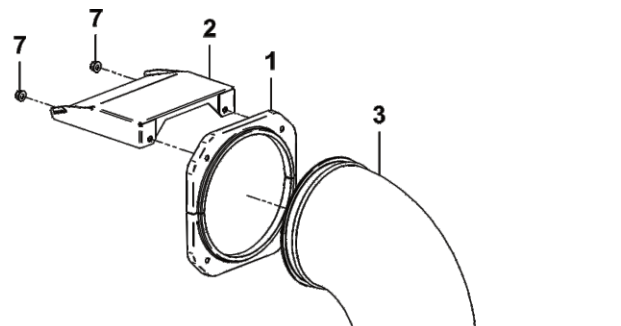
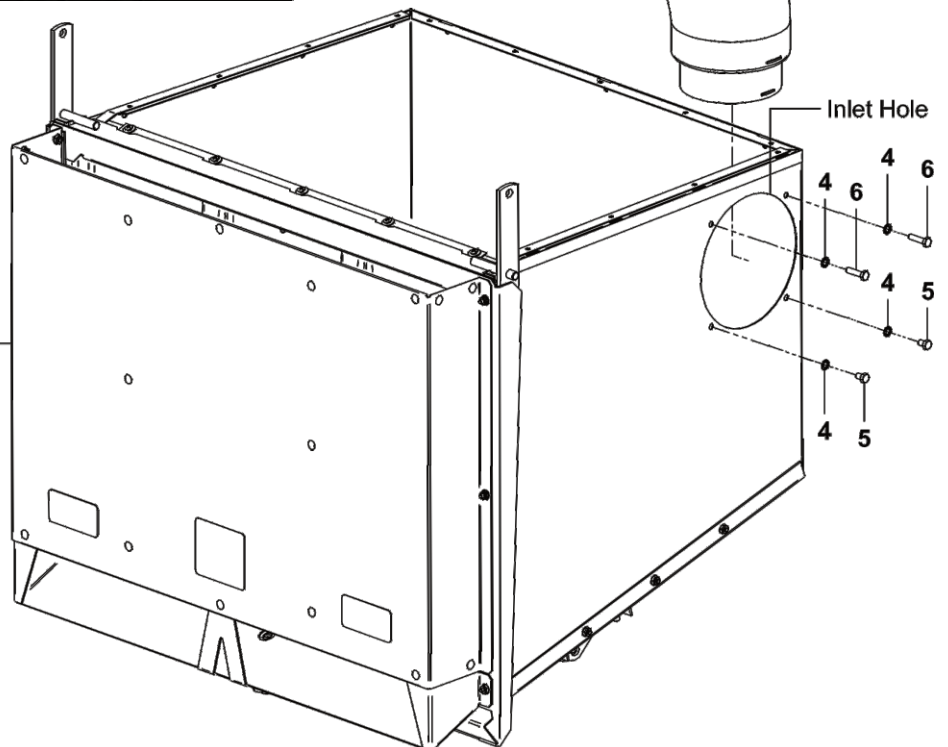

Figure B

| Item # | Part # | Desc. | Qty. |
|--------|--------|-----------------------------|------|
| 1 | C0074 | Inlet Ring | 1 |
| 2 | C0088 | Debris Deflector | 1 |
| 3 | V0025 | Universal Inlet / 6" & 7" | 1 |
| 4 | K0044 | I/T Tooth Lock Washer 5/16" | 4 |
| 5 | K1152 | HHCS 5/16"-18 x 1/2" | 2 |
| 6 | K1156 | 5/16"-18 x 1-1/4" HHCS | 2 |
| 7 | K2516 | Ny-Flange Lock Nut 5/16"-18 | 2 |



Open Box Door
to Install
Inlet,
Inlet Ring &
Debris Deflector



Note: Box Top & Screen Removed
in Figure for visual clarity.

Blower Cone Installation

Thread (1) 5/16"-18 Jam Nut P#(K0120) onto each end of (2) 5/16"-18 x 2-1/2" HHCS P#(K0125) as shown in Figure A.

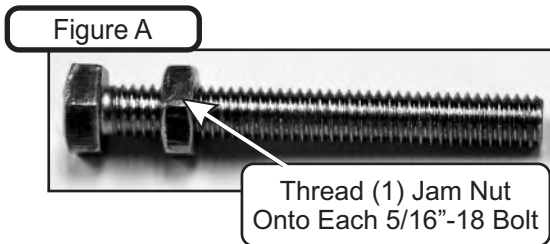

Now partially thread (1) bolt into each of the two threaded bosses located on the Blower Housing. Place 8" Blower Cone P#(E6009) so the two tabs line up with the bolts and tighten completely as shown in Figure B.

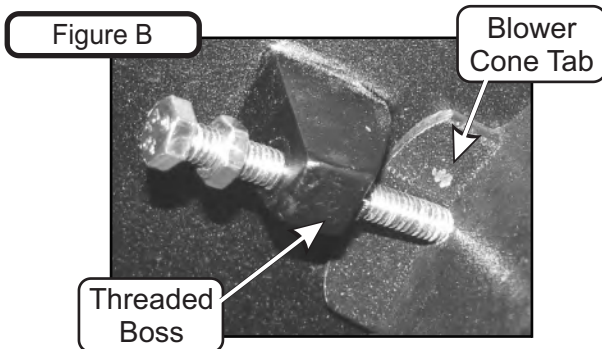

Once the (2) bolts are tight, tighten the Jam Nuts against the threaded boss as shown in Figure C.

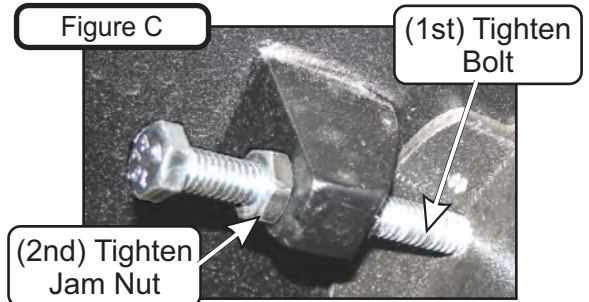

Refer to Figure D for proper Blower Cone installation reference.

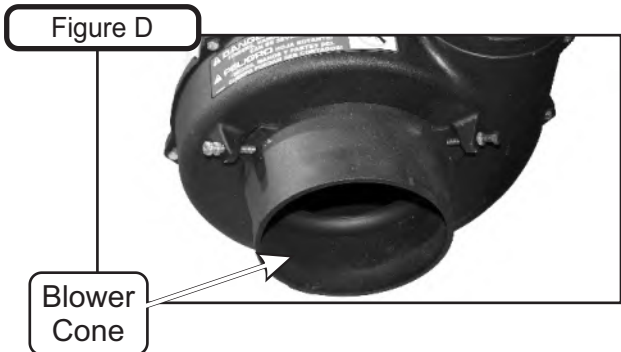

Wiring Harness Installation



WARNING

**To Prevent Serious Injury-
Proper Installation Of Safety Interlock Harness
Is Mandatory. Please Check That All Interlock
Points Work Correctly Once Installed.**

First, install the PTO Rocker Switch (Item #2) by positioning it over the Switch Mount Plate (Item #1) and firmly pressing the Rocker Switch down until it is seated in place (Refer to Figure A). Next, connect the Wire Harness' (2) Female Switch Disconnects (Refer to Figure B) to the PTO Rocker Switch. See Figure E on Page 24 for complete Wiring Diagram.

Then, position the PTO Switch Mount onto the panel Right of the Operator's seat and drill two 1/4" holes. Secure the PTO Switch Mount by using (2) 1/4"-20 x 3/4" HHCS and (2) 1/4"-20 Ny-Flange Lock Nuts.

Next, route the Negative Lead (-) and the Positive Lead (+) of the Wire Harness P#(P0298) (Refer to Figure C) to the negative & positive terminal of the mower's battery. Then, disconnect the mower's clutch connector and interconnect with the Wire Harness' Clutch Connection Jumper. Be sure to identify and pick the correct Jumper depending on your mower's clutch connection type. Refer to the Wiring Diagram on Page 28 for the Connection Jumper Types.

Finally, route the Wire Harness back towards the rear of the mower positioning the Wire Harness under the Right Frame Bracket then connect the Wire Harness to the PTO Unit. Refer to Figure D.

Note: It is recommended to secure the Wire Harness to the mower by using the (4) included Cable Ties P#(J0245) once you have the Wire Harness installed. Be sure the Wire Harness is routed so that it does not obstruct the seat as it is being lowered down or any part of the mower that may damage the Harness.

Figure A

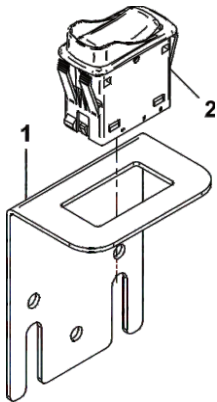

| Item # | Part # | Desc. | Qty. |
|--------|--------|------------------------------|------|
| 1 | B2601 | Switch Mount / PTO-X | 1 |
| 2 | P0293 | PTO Engagement Rocker Switch | 1 |

Figure D

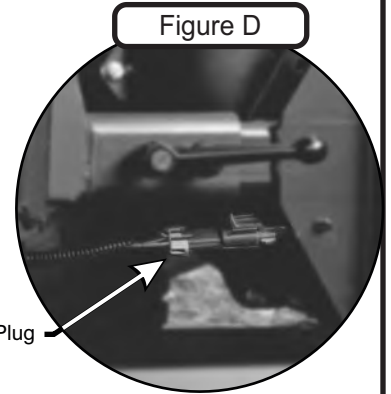

Figure B

(#2) PTO Switch

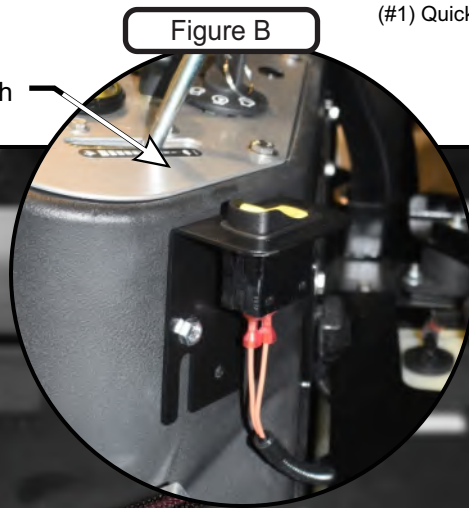
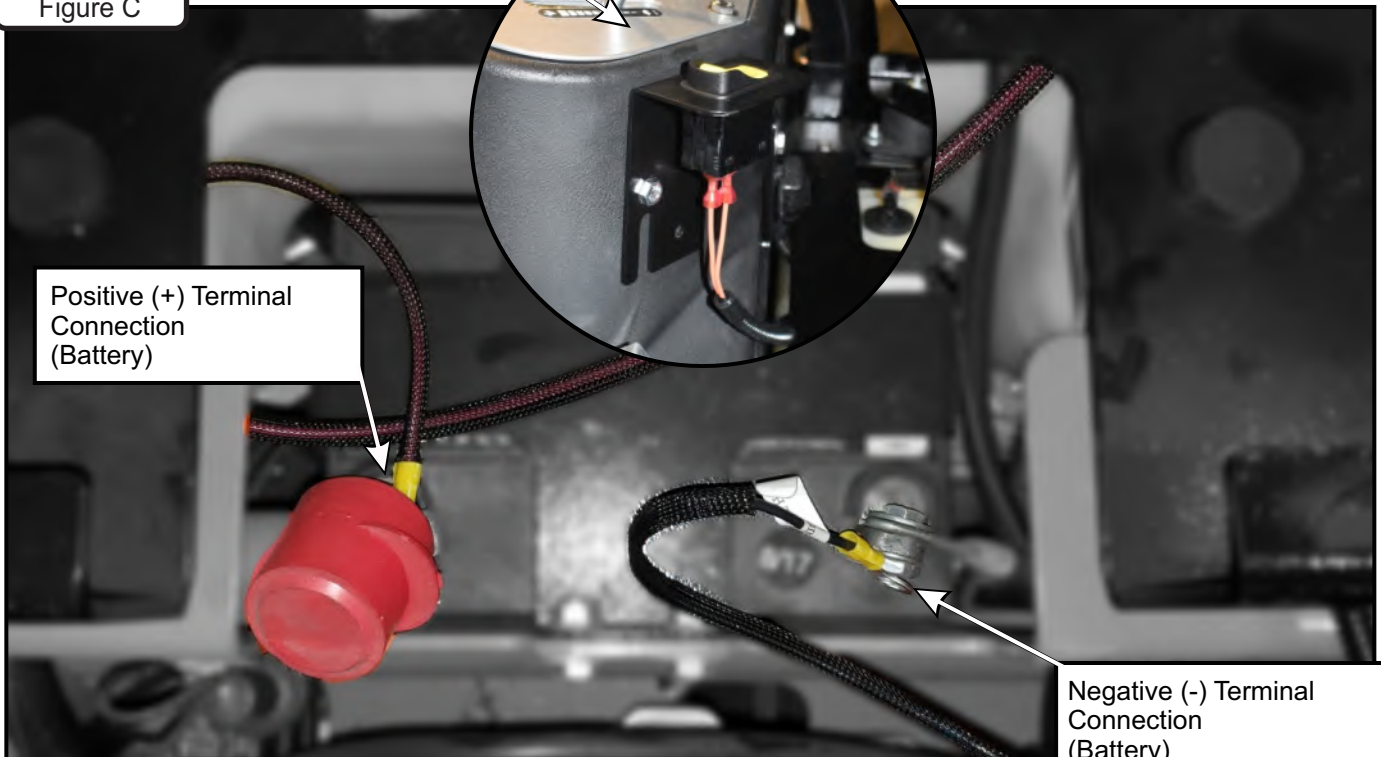

Figure C



Wire Harness Installation (Continued)

Figure E

Note: Select the Jumper that fits your mower's clutch connection and connect it to the Wire Harness' Connector Jumper

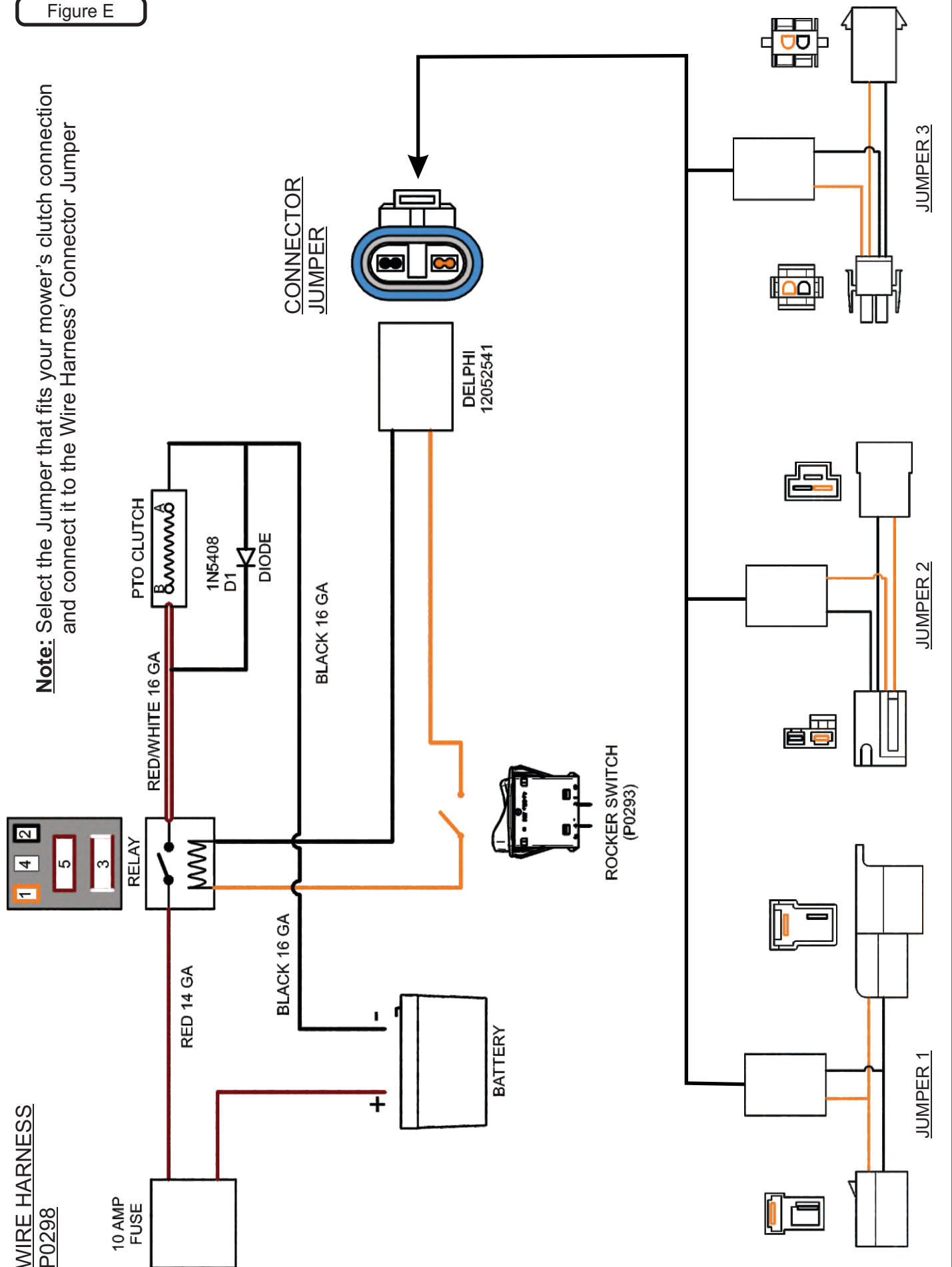

WIRE HARNESS
P0298

10 AMP
FUSE

RED 14 GA

RELAY

RED/WHITE 16 GA

PTO CLUTCH

1N5408
D1

DIODE

BLACK 16 GA

BLACK 16 GA

CONNECTOR
JUMPER

DELPHI
12052541

ROCKER SWITCH
(P0293)

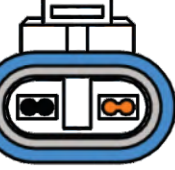

JUMPER 1

JUMPER 2

JUMPER 3

Length Of Hose Adjustment

The hoses in the following steps must be cut to fit your machine. Do not cut the hoses until you have tried to fit them on your machine. Remember that the hoses need to be long enough to allow for the opening and closing of the collection system as well as allowing ample clamping surface between each component.

Upper Hose Installation

Slide a Hose Clamp P#(J0060) over one end of the 6" Upper Hose. Secure this end of the 6" Upper Hose to the Blower Outlet. See Figure below for details. Secure opposite end of the 6" Upper Hose to the Inlet with another Hose Clamp P#(J0060). Make sure both ends are securely fastened by tightening the Hose Clamp.

Lower Hose To Blower Cone Installation

Slide a Hose Clamp P#(J0080) over both ends of the Lower Hose. Secure one end of the Lower Hose to the Blower Cone and fasten by tightening the Hose Clamp.

Lower Hose To Boot Installation

Take the unattached end of the Lower Hose and secure it to the circular end of the Boot and fasten by tightening the Hose Clamp.

Tip: Before securing Hose Clamp fully, rotate Lower Hose counter-clockwise (away from yourself) approximately 1" to aid in retaining Boot to mower deck.

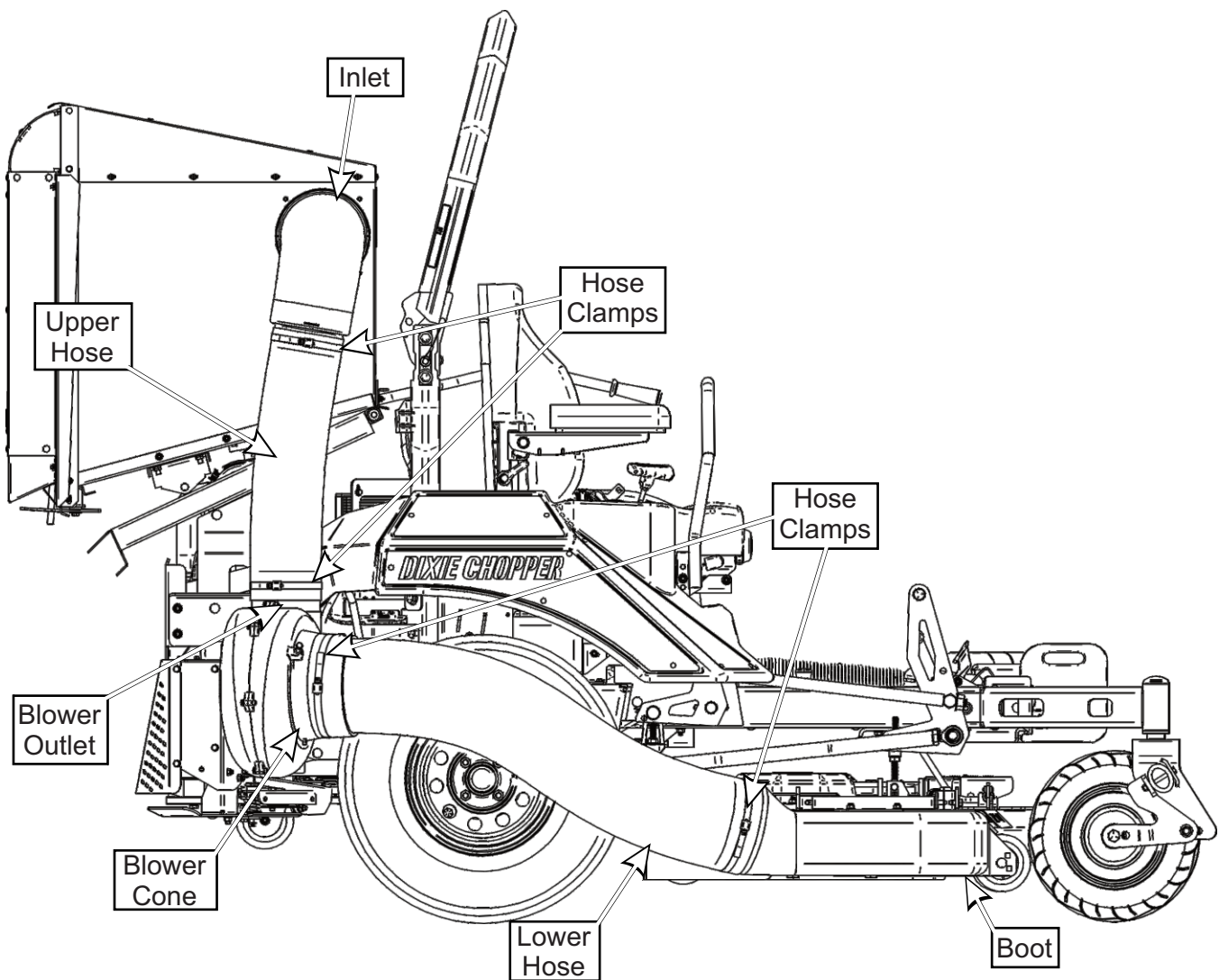

Impeller Blade Removal/Replacement

To Remove: First remove the 5/16"-24 x 1" HHCS P#(K0428) (#1), Taper Lock Bushing Washer P#(K0284) (#3), (2) 5/16 Flat Wahers P#(K0042) and Spacer Bushing P#(S0159) (#4) from the Taper-Lock Bushing P#(S0157) (#5). Next remove the (2) 1/4"-20 x 1" HHCS (#2) and place them into the threaded holes of the Taper-Lock Bushing (#5). Gradually thread each bolt evenly into the Taper-Lock Bushing, forcing the blade to break-away from the Taper-Lock Bushing. If the Impeller will not move, carefully hit the base of the Impeller, between each vein, with a hammer, then try again.

To Replace: Place Impeller Blade over the engine shaft. Slide the Taper-Lock Bushing (#5) on to the engine shaft and into the Impeller Blade, aligning the **non-threaded** holes of the Taper-Lock Bushing to the threaded holes of the Impeller Blade. Fasten by using (2) 1/4"-20 x 1" HHCS (#2), (1) Spacer Bushing (#4) (1) Taper-Lock Bushing Washer (#3), and (1) 5/16"-24 x 1" HHCS (#1). Torque to the proper specifications in the torque chart on the back of this manual. Next, rotate the Impeller Blade to ensure that the blade is clear of contact on all sides of the blower housing.

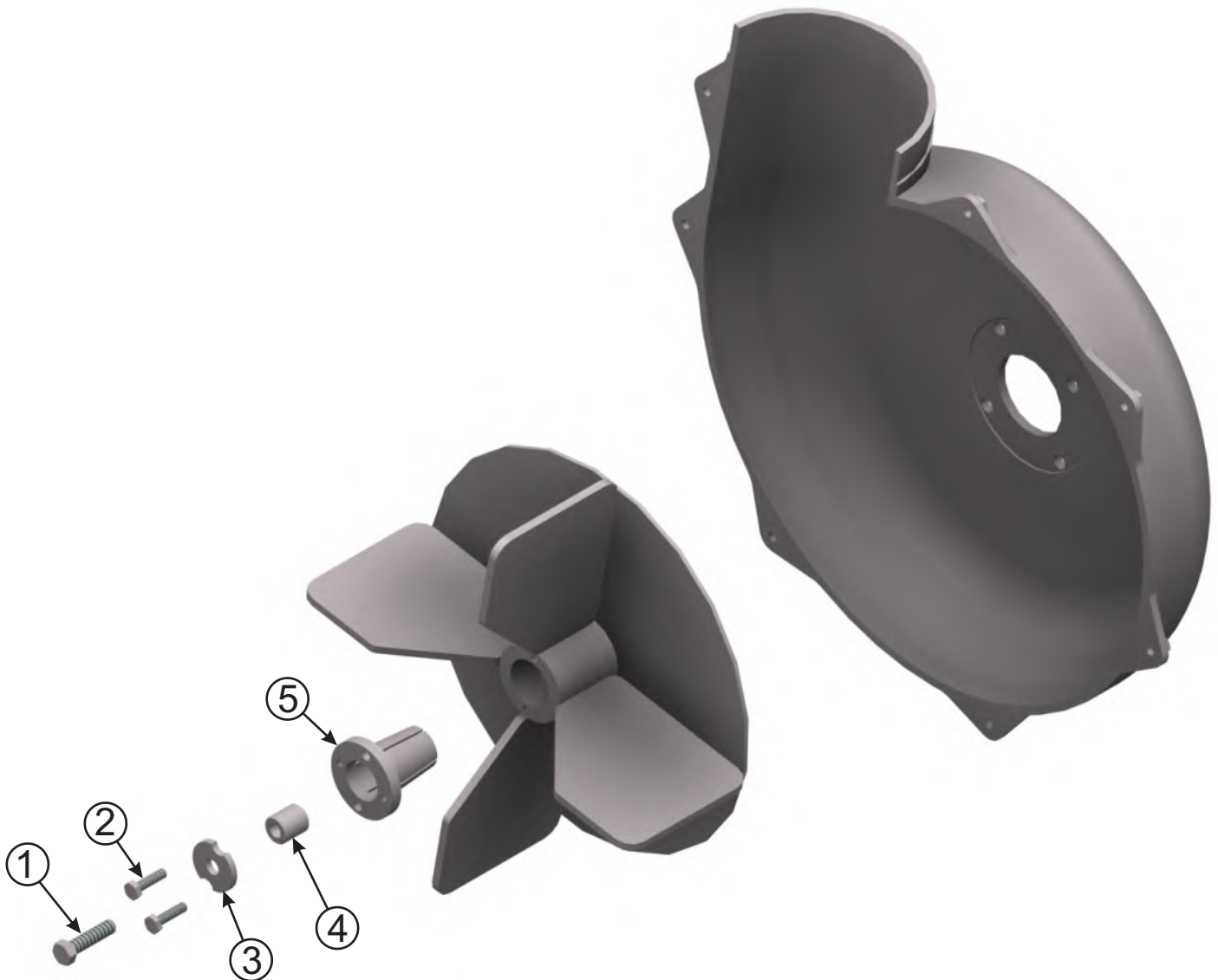

Weight Kit Installation

Quad Weight Kit

Go to page 30 for the installation instructions of the (4) Suitcase Weights P#(Y0025).

First, remove the existing front name plate by removing the top (2) set of hardware and bottom (2) set of hardware. Refer to Figure A (Dixie Chopper Unit shown).

Figure A

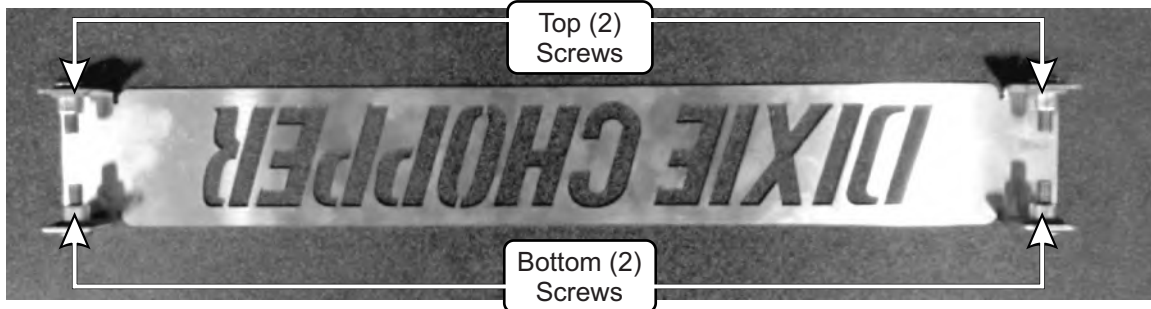

Next, remove the footrest to expose (4) large carriage bolts and nuts, located behind the name plate. Remove and keep (2) existing nuts from the existing carriage bolts, (1) from the far left and (1) from the far right. Refer to Figure B.

With the nuts removed, place the Quad Weight Bracket P#(B2602) over the front of the mower, under the footrest and over the exposed bolts as shown in Figure B. Secure the Quad Weight Bracket by reusing the (2) nuts removed earlier to the existing carriage bolts. Refer to Figure C for the installed Quad Weight Bracket.

Note: Some part and part features have been hidden from view for visual clarity.

Figure B

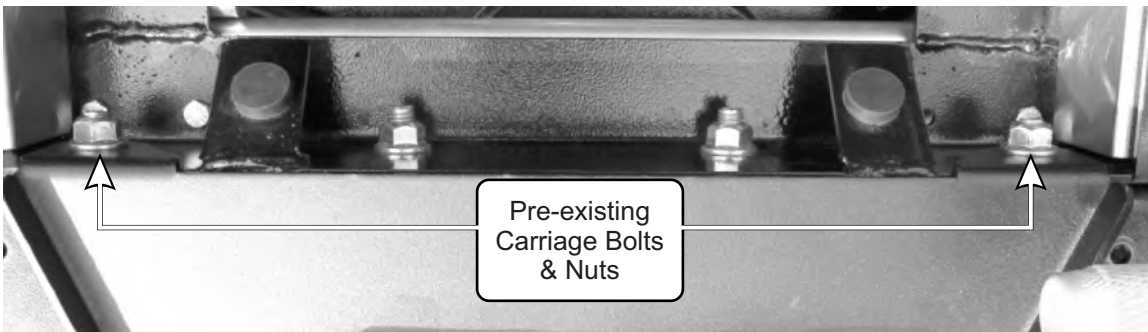
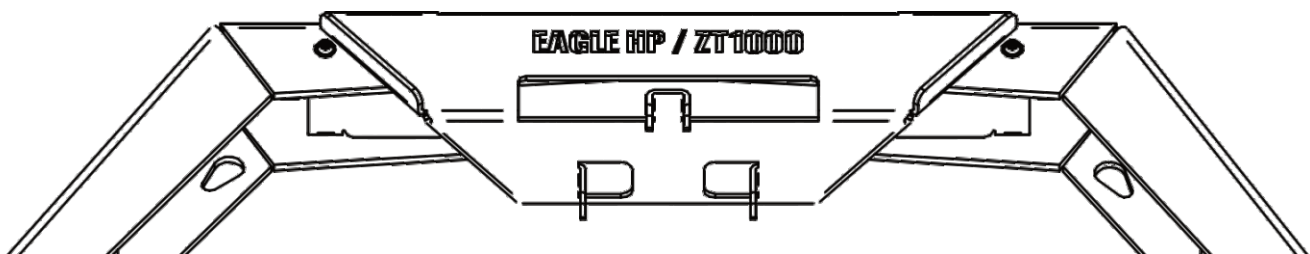

Figure C



Weight Kit Installation (Continued)

Dual Weight Kit - Left Caster

Go to page 30 for the installation instructions of the (2) Suitcase Weights P#(Y0025).

First, Install the Caster Weight / Support Bracket (Item #2) onto the Dual Weight / Caster Bracket (Item #1) by using (2) 3/8-16" x 1" Carriage Bolts (Item #5.1) and (2) 3/8-16" Ny-Flange Lock Nuts (Item #5.3). Refer to Figure D.

Next, position and align the Caster Weight / Brace (Item #3) and the installed Support Bracket (Item #2) on to the mower's caster as shown in Figure D. Place the Caster Brace on the inside of the Caster and the Support Bracket on the outside of the Caster. Secure the Caster Brace onto the Support Bracket by using (2) 3/8-16" x 1-1/4" Carriage Bolts (Item #5.2) and (2) 3/8-16" Ny-Flange Lock Nuts (Item #5.3). Leave hardware loose enough to be adjusted.

Figure D

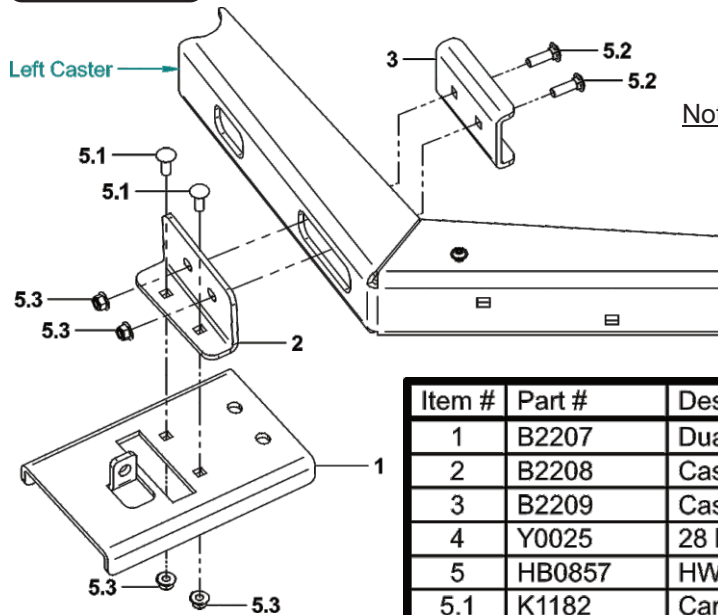

Note: Position the bolt holes with the through holes of the Caster.

Leave hardware relatively loose on this step.

| Item # | Part # | Desc. | Qty. |
|--------|--------|---|------|
| 1 | B2207 | Dual Weight / Caster Bracket / Eagle HP | 1 |
| 2 | B2208 | Caster Weight / Support Bracket | 1 |
| 3 | B2209 | Caster Weight / Brace | 1 |
| 4 | Y0025 | 28 lb. Suitcase Weight | 2 |
| 5 | HB0857 | HW Bag / Dual Weight Kit / Eagle HP | 1 |
| 5.1 | K1182 | Carriage Bolt 3/8"-16 x 1" | 2 |
| 5.2 | K1183 | Carriage Bolt 3/8"-16 x 1-1/4" | 2 |
| 5.3 | K2038 | Ny-Flange Lock Nut 3/8"-16 | 4 |
| 5.4 | K0342 | 1/2"-13 x 1-1/4" HHCS | 1 |
| 5.5 | K1521 | 1/2" Flat Heavy Washer | 1 |
| 5.6 | K1247 | 1/2"-13 Nyloc Nut | 1 |
| 5.7 | A0312 | Hitch Pin Weldment | 1 |
| 5.8 | K1478 | Hair Pin Cotter / Double Loop | 1 |

Figure E

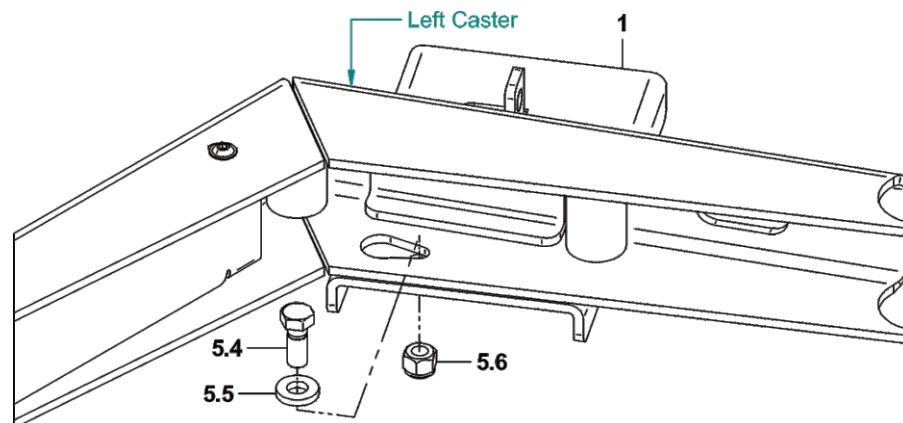

Then, position and align the Dual Weight / Caster Bracket's (Item #1) rear bolt hole to the hole on the inside of the mower's Caster. Refer to Figure E above. Once aligned, secure the Dual Weight / Caster Bracket by using (1) 1/2"-13 x 1-1/4" HHCS (Item #5.4), (1) 1/2" Flat Heavy Washer (Item #5.5) and (1) 1/2"-13 Nyloc Nut (Item #5.6).

Tighten all hardware at this time.

Weight Kit Installation (Continued)

Suitcase Weight Installation

Insert (2) Suitcase Weights (Item #2) on to the Weight Bracket (Item #1) & align the mount hole of the Weights w/ the hole on the Weight Bracket tab. Fasten the Weight to the Weight Bracket using (1) Hitch Pin (Item #3.1) and (1) Hair Pin Cotter (Item #3.2).

See Figure F for the Quad Weight Kit and Figure G for the Dual Weight Kit.

Figure F

| Item # | Part # | Desc. | Qty. |
|--------|--------|--------------------------------------|------|
| 1 | B2602 | Quad Weight Bracket / Eagle HP | 1 |
| 2 | Y0025 | 28 lb. Suitcase Weight | 4 |
| 3 | HB0695 | HW Bag / Weight Kit / Dixie Jacobsen | 1 |
| 3.1 | A0312 | Hitch Pin Weldment | 2 |
| 3.2 | K1478 | Hair Pin Cotter / Double Loop | 2 |

Quad Weight Kit

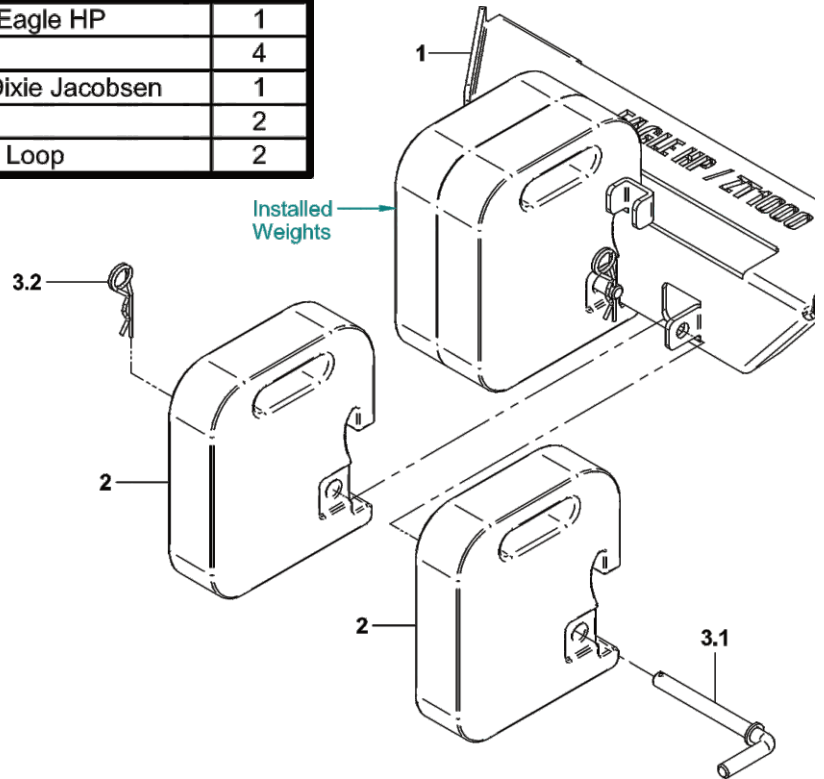
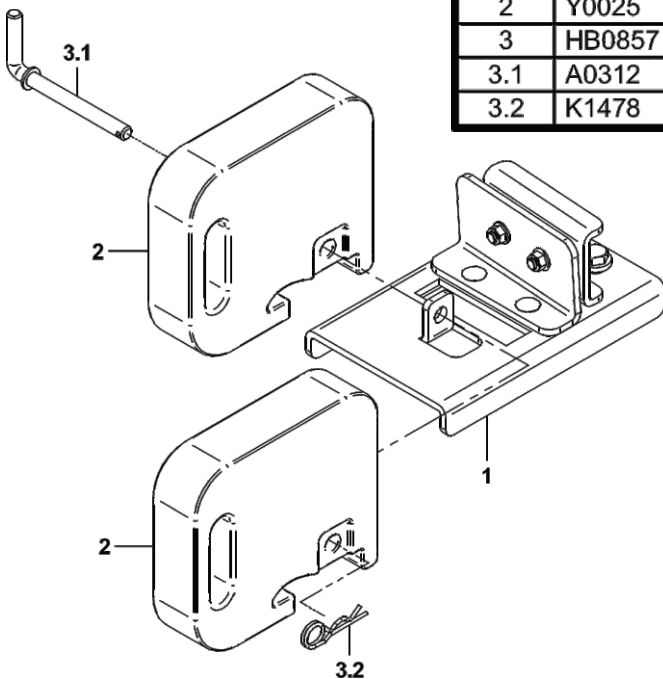

Figure G

| Item # | Part # | Desc. | Qty. |
|--------|--------|---|------|
| 1 | B2207 | Dual Weight / Caster Bracket / Eagle HP | 1 |
| 2 | Y0025 | 28 lb. Suitcase Weight | 2 |
| 3 | HB0857 | HW Bag / Dual Weight Kit / Eagle HP | 1 |
| 3.1 | A0312 | Hitch Pin Weldment | 1 |
| 3.2 | K1478 | Hair Pin Cotter / Double Loop | 1 |

Dual Weight Kit



A2207 Mount Arm / Tube Assembly Exploded Parts View

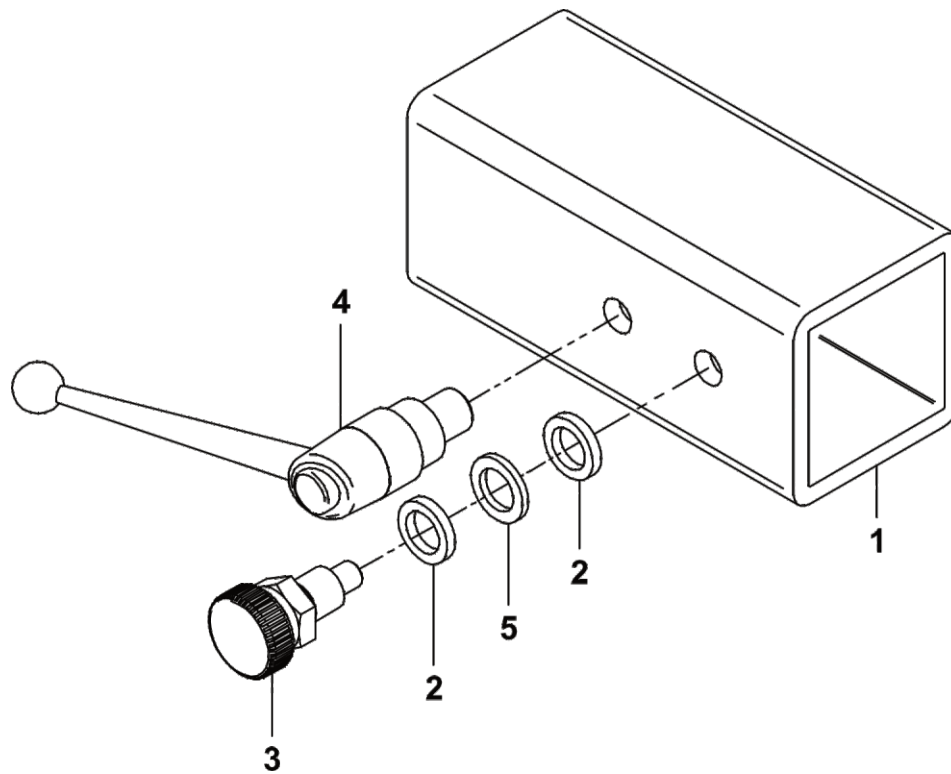

| Item # | Part # | Desc. | Qty. |
|--------|--------|---|------|
| 1 | B0931 | Tube / Mount Arm | 1 |
| 2 | J0013 | Nylon Flat Washer 1/2" x .750" OD Grade 6/6 | 2 |
| 3 | J0020 | Knob Plunger Pin 1/2"-13 | 1 |
| 4 | J0009 | Adjustable Handle 1/2"-13 x .59 Male | 1 |
| 5 | K0027 | Flat Washer 1/2" / .787 OD x .512 ID x .090 T | 1 |

A2092 Idler Arm Assembly

| Item # | Part # | Desc. | Qty. |
|--------|----------|--------------------------|------|
| 1 | A2070_01 | Idler Arm Weldment | 1 |
| 2 | K1467 | Flat Washer M6 x 12mm OD | 1 |
| 3 | J0801 | 1/4"-28 Zirc Fitting | 1 |

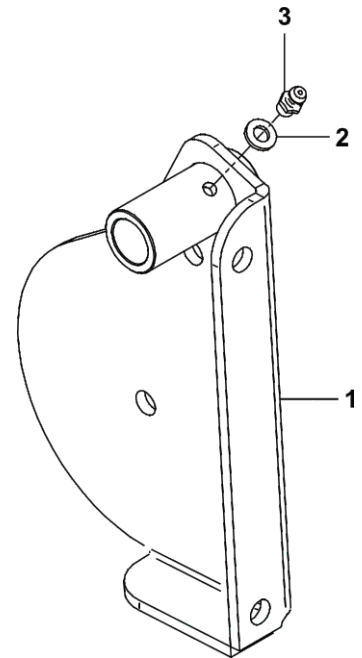

A2067 02 Idler Mount Assembly

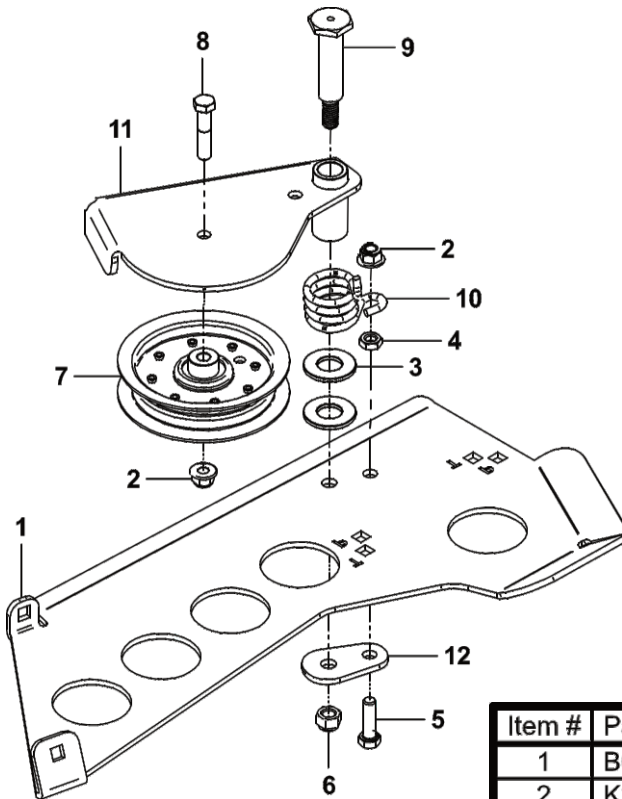

| Item # | Part # | Desc. | Qty. |
|--------|----------|---|------|
| 1 | B0958_02 | Idler Mnt Pl | 1 |
| 2 | K2038 | Ny-Flange Lock Nut 3/8"-16 | 2 |
| 3 | K1463 | Flat Washer .720 ID x 1.500 OD x .250 T | 2 |
| 4 | K1219 | Jam Nut 3/8"-16 | 1 |
| 5 | K1192 | HHCS 3/8"-16 x 1-1/4" GR5 | 1 |
| 6 | K0329 | Nylock Nut 7/16"-14 GR8 | 1 |
| 7 | M0003 | Idler Pulley | 1 |
| 8 | K1462 | HHCS 3/8"-16 x 1-3/4" GR8 | 1 |
| 9 | K1464 | Shoulder Bolt 7/16"-14 / Idler | 1 |
| 10 | J0024 | Torsion Spring | 1 |
| 11 | A2092 | Idler Arm Assy. | 1 |
| 12 | B0974 | Idler Base Plate | 1 |

A2058 01 Gearbox Sub-Assembly Exploded Parts View

| Item # | Part # | Desc. | Qty. |
|--------|--------|-------------------------------------|------|
| 1 | A2048 | Clutch Flange | 1 |
| 2 | M0002 | Gearbox | 1 |
| 3 | N0005 | 7/8" Pillow Block Bearing / Fenner | 1 |
| 4 | J0272 | Woodruff Key #9 | 1 |
| 5 | K0035 | Set Screw 5/16"-18 x 1/4" Cup Point | 1 |
| 6 | K0428 | HHCS 5/16"-24 x 1" GR8 | 1 |
| 7 | K0043 | Lock Washer 5/16" | 1 |

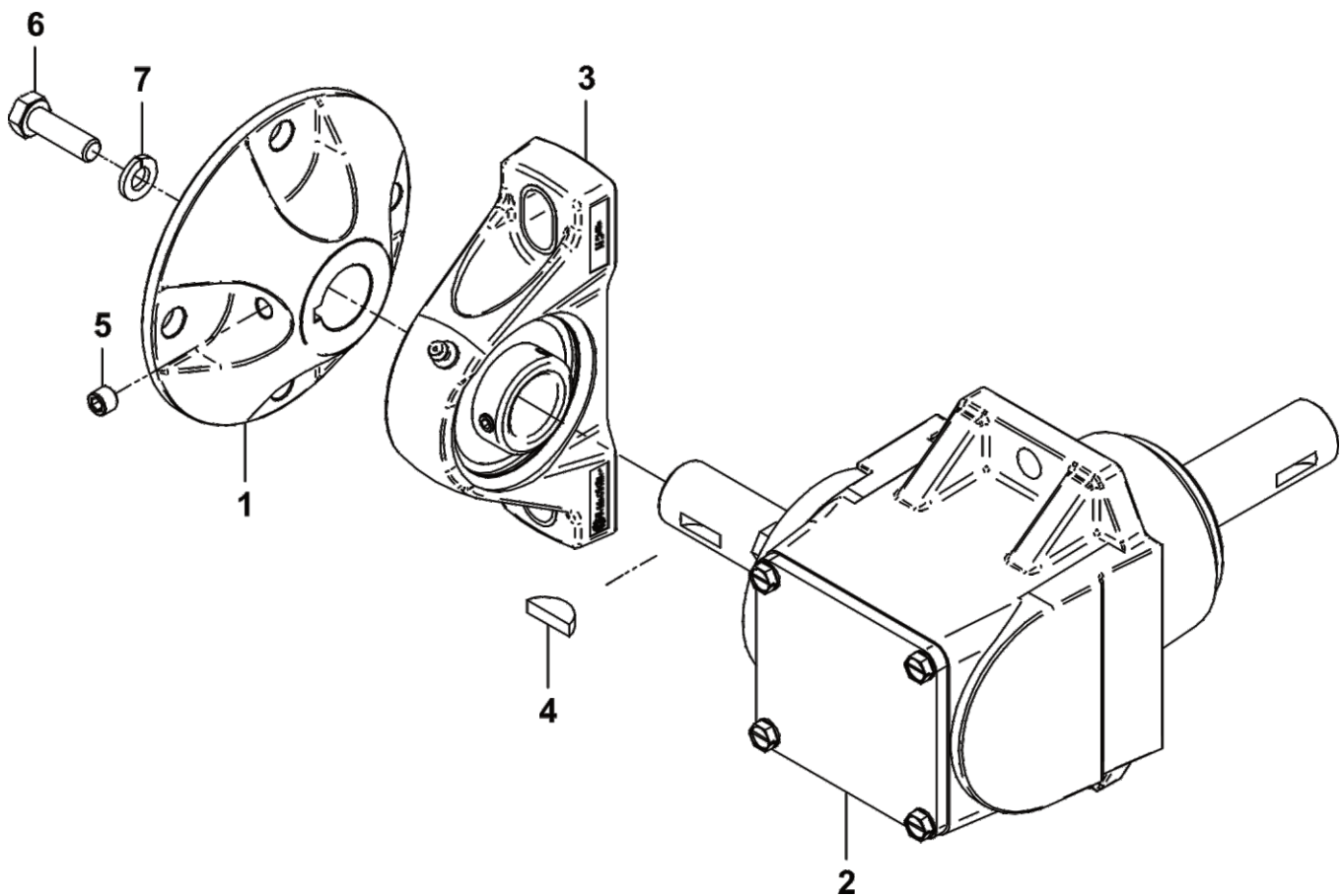

A2059 02 Clutch Sub-Assembly Exploded Parts View

| Item # | Part # | Desc. | Qty. |
|--------|----------|--|------|
| 1 | M0001_01 | Electric Clutch | 1 |
| 2 | S0007 | Clutch Shaft (Rev 1) | 1 |
| 3 | N0004 | Flange Bearing / 1" ID / 2-Bolt | 1 |
| 4 | B2217 | Clutch Lower Bearing Mnt. | 1 |
| 5 | S0239 | Eng. Pulley Bushing #41 | 1 |
| 6 | K0076 | Key 1/4" x 3/4" Long | 1 |
| 7 | M0309 | A-Section Pulley / 4.75 OD (PTO-X) | 1 |
| 8 | K1510 | HHCS 3/8"-16 x 1-1/8" GR5 Zinc | 2 |
| 9 | K1121 | 3/8"-16 Nyloc Nut GR5 | 2 |
| 10 | K0359 | HHCS / 7/16"-20 x 4" w/ Patch | 1 |
| 11 | K0140 | Lock Washer 7/16" / High-Collar Helical Spring | 1 |
| 12 | K0278 | Double Indented Washer 7/16" / 1.375 OD x .440 ID x .179 T | 1 |

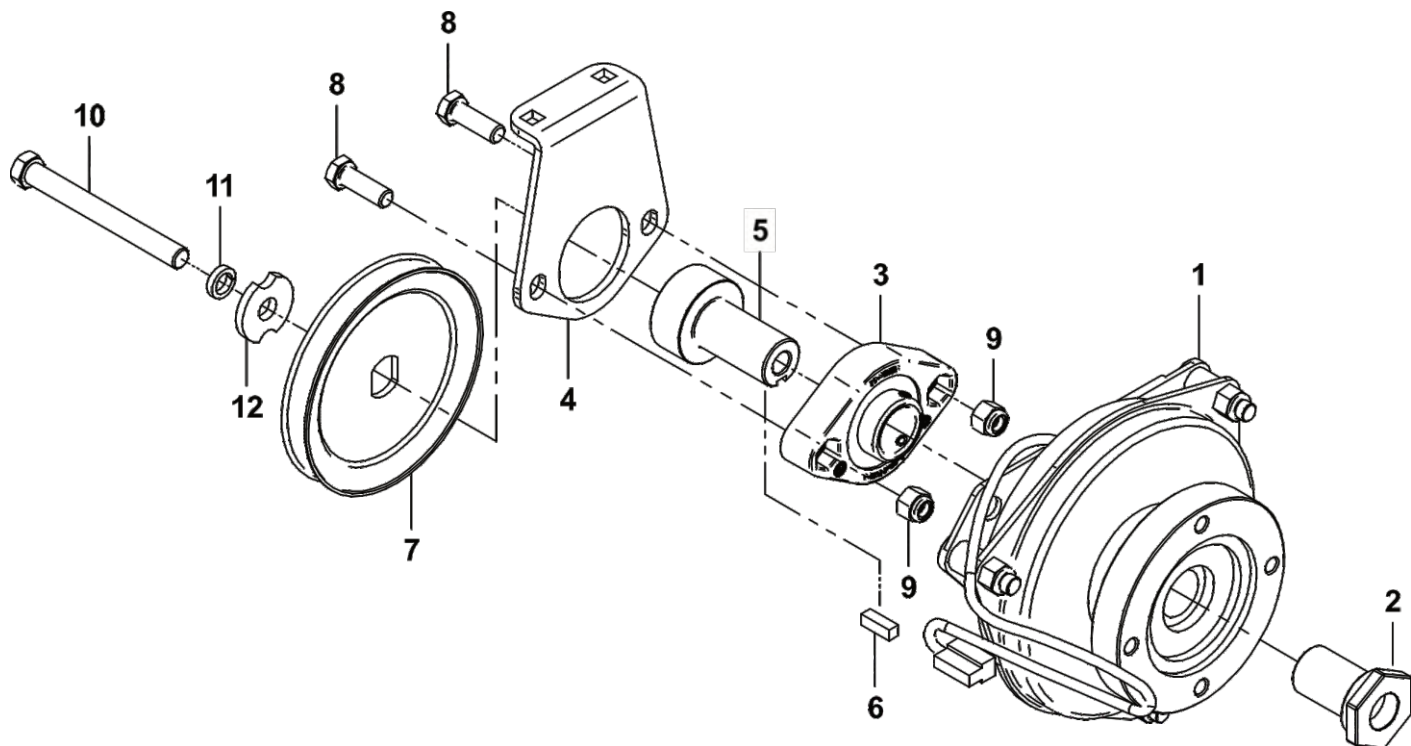

A2057 02 Drive Assembly Exploded Parts View

| Item # | Part # | Desc. | Qty. |
|--------|----------|-------------------------|------|
| 1 | A2058_01 | Gearbox Sub-Assy | 1 |
| 2 | A2059_02 | Clutch Sub-Assy | 1 |
| 3 | K0343 | HHCS 3/8"-16 x 7/8" GR8 | 4 |
| 4 | K0048 | Lock Washer 3/8" | 4 |

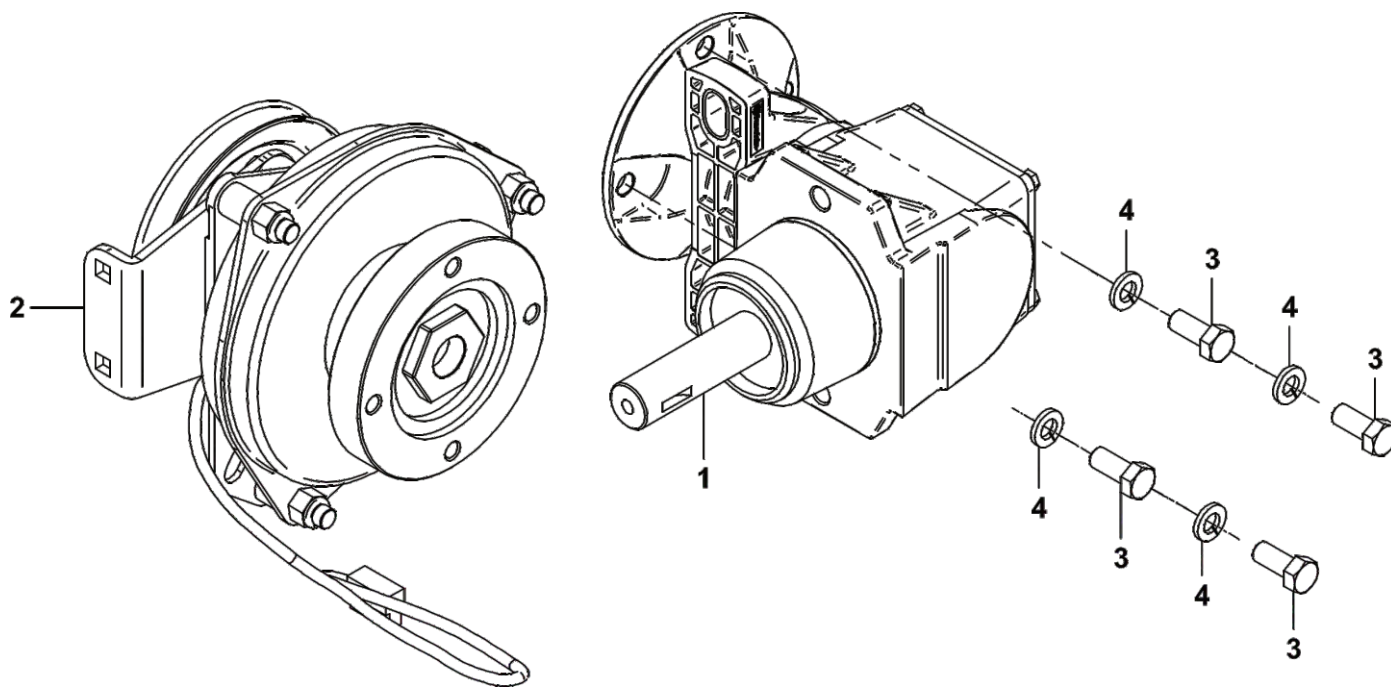

A2060 02 Mounted Drive Assembly
Exploded Parts View

| Item # | Part # | Desc. | Qty. |
|--------|----------|-----------------------------|------|
| 1 | A2034 | Drive Mnt Assy | 1 |
| 2 | A2057_02 | Drive Assy | 1 |
| 3 | B0940 | Spacer Plate | 1 |
| 4 | K1511 | SHCS 1/2"-13 x 2" A574 Zinc | 2 |
| 5 | K0057 | Lock Washer I/T 1/2" / Zinc | 2 |
| 6 | K1512 | SHCS 3/8"-16 x 1" A574 Zinc | 2 |
| 7 | K0048 | Lock Washer 3/8" | 2 |

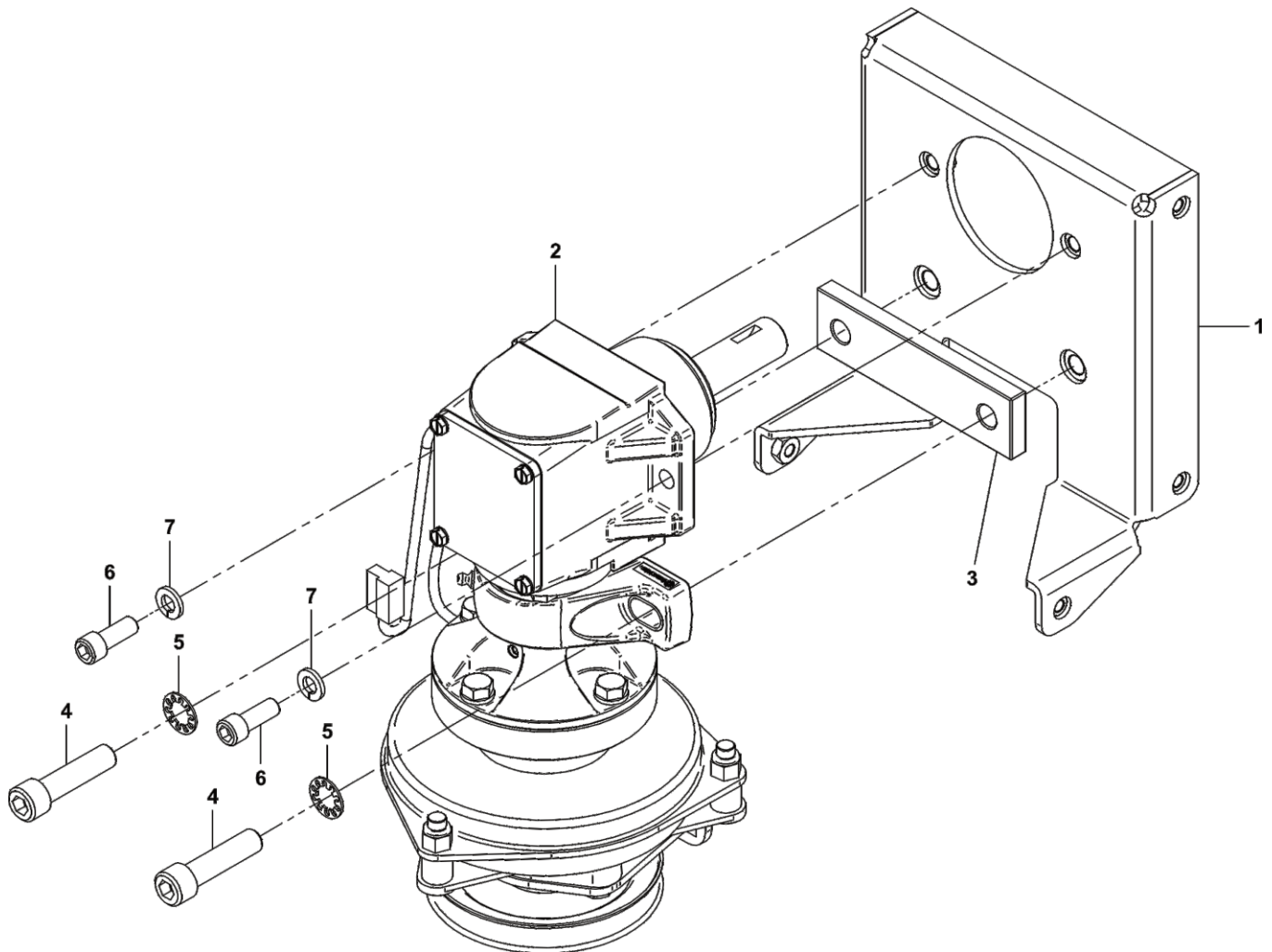

A2039 03 Base Drive Assembly

Exploded Parts View

| Item # | Part # | Desc. | Qty. |
|--------|----------|---|------|
| 1 | A2060_02 | Mounted Drive Assy | 1 |
| 2 | A2035_02 | Housing Mnt Assy | 1 |
| 3 | B1100_01 | Idler Assy Mount Plate | 1 |
| 4 | B0942_02 | Anti-Rotation Brkt | 1 |
| 5 | A2032 | Drive Arm Assy | 1 |
| 6 | B0938_01 | Drive Guard | 1 |
| 7 | K1153 | HHCS 5/16"-18 x 3/4" | 4 |
| 8 | K1154 | HHCS 5/16"-18 x 1" | 4 |
| 9 | K0043 | Lock Washer 5/16" | 8 |
| 10 | K1142 | 5/16"-18 x 3/4" Carriage Bolt | 6 |
| 11 | K2516 | Ny-Flange Lock Nut 5/16"-18 | 6 |
| 12 | K0343 | HHCS 3/8"-16 x 7/8" GR8 | 1 |
| 13 | K1477 | Flat Washer / 3/8" / .406 ID x .812 OD x .125 Thk | 1 |
| 14 | K1476 | Reverse Lock Nut / 3/8"-16 Grade C | 1 |
| 15 | P0271 | Quick Connect Wire Harness | 1 |
| 16 | K0353 | HWHTCS 1/4"-20 x 1/2" | 2 |

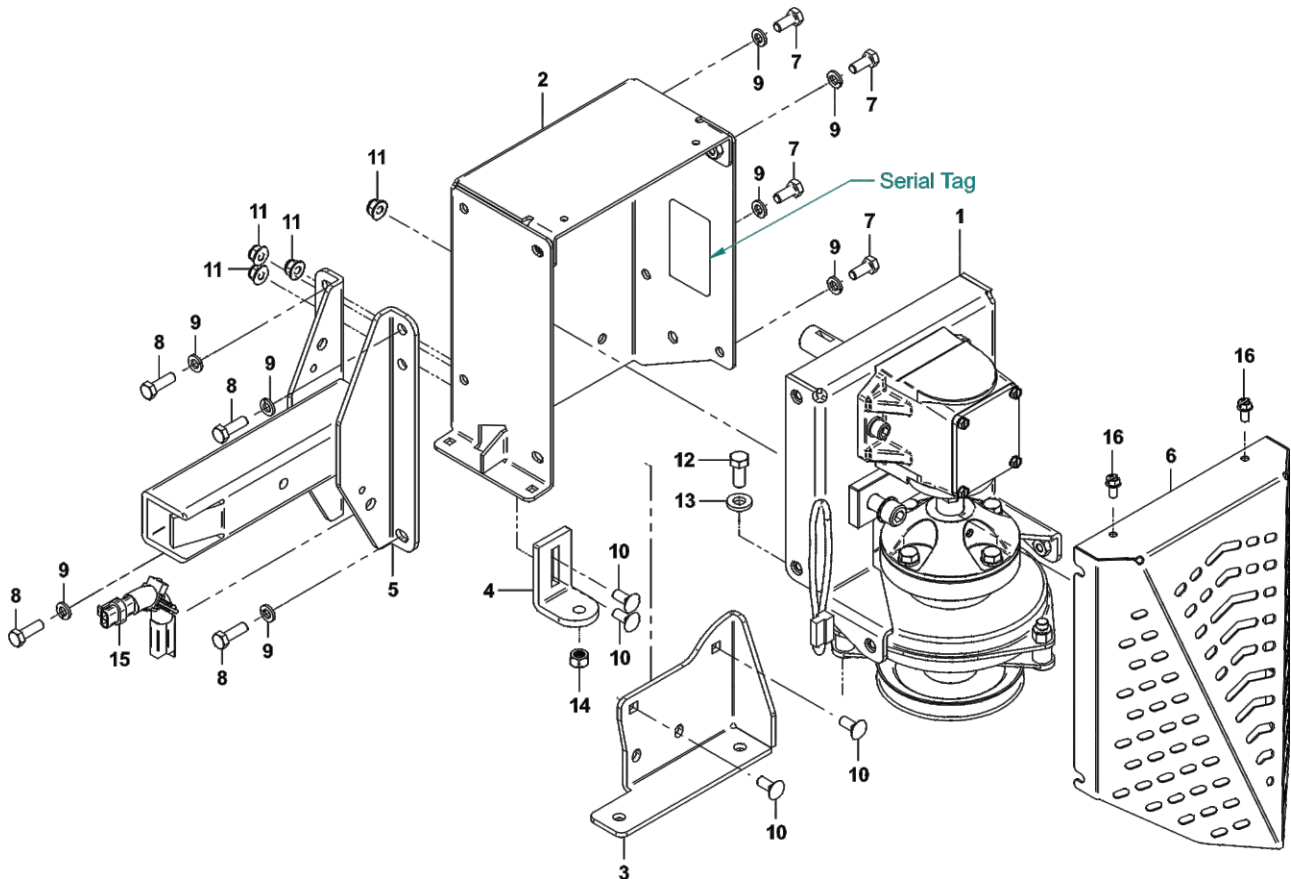

A2061 03 Drive Assembly / 4 Blade Impeller

Exploded Parts View

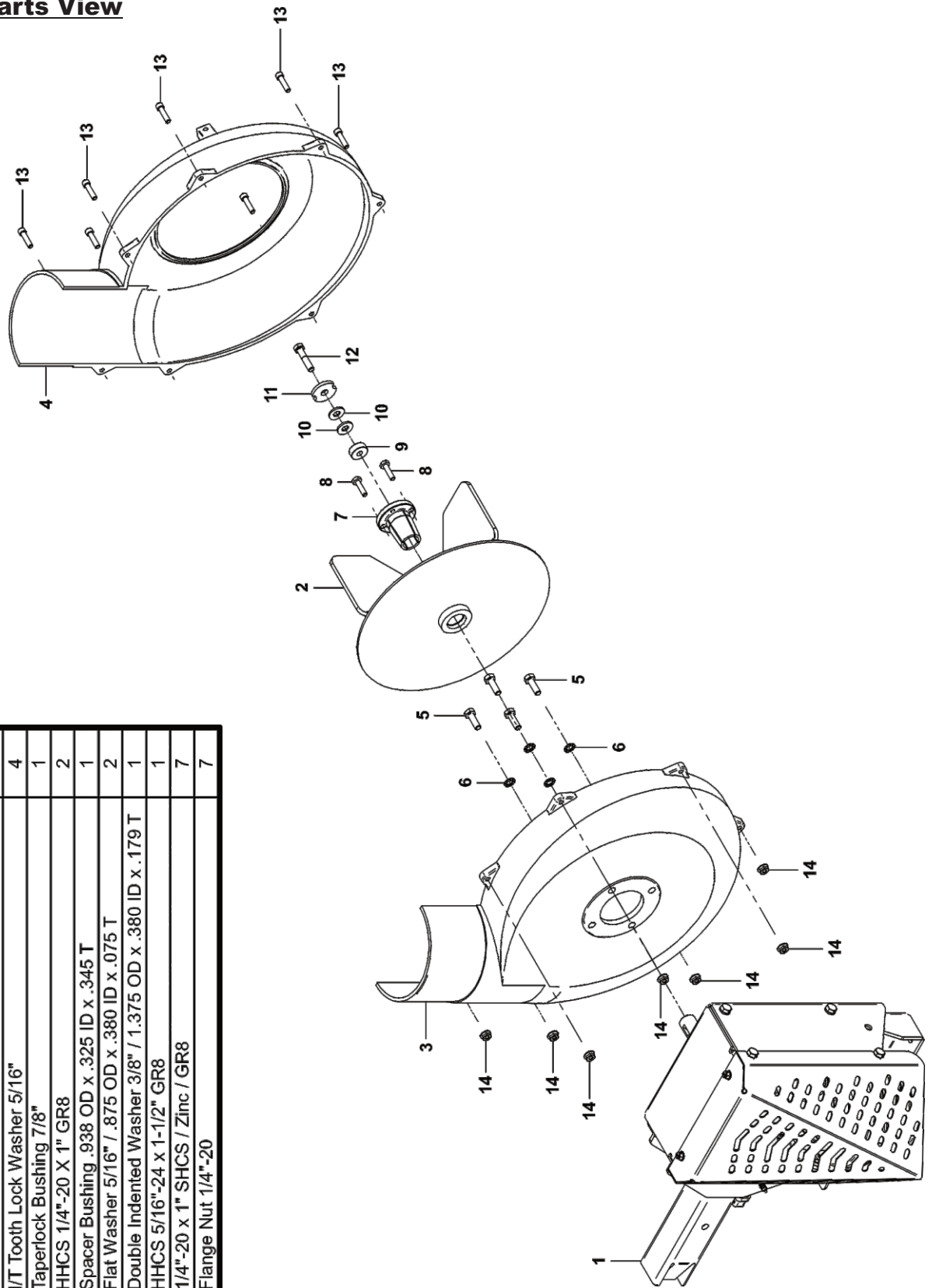

| Item # | Part # | Desc. | Qty. |
|--------|----------|---|------|
| 1 | A2039 03 | Drive Assy / Base 1.5 | 1 |
| 2 | A0645 | 4-Blade Impeller Weldment | 1 |
| 3 | E4052B | Blower Hsg Back | 1 |
| 4 | E4052F | Blower Hsg Front | 1 |
| 5 | K1154 | HHCS 5/16"-18 x 1" | 4 |
| 6 | K0044 | I/T Tooth Lock Washer 5/16" | 4 |
| 7 | S0157 | Taperlock Bushing 7/8" | 1 |
| 8 | K1225 | HHCS 1/4"-20 X 1" GR8 | 2 |
| 9 | S0159 | Spacer Bushing .938 OD x .325 ID x .345 T | 1 |
| 10 | K0042 | Flat Washer 5/16" / .875 OD x .380 ID x .075 T | 2 |
| 11 | K0284 | Double Indented Washer 3/8" / 1.375 OD x .380 ID x .179 T | 1 |
| 12 | K1465 | HHCS 5/16"-24 x 1-1/2" GR8 | 1 |
| 13 | K1401 | 1/4"-20 x 1" SHCS / Zinc / GR8 | 7 |
| 14 | K1126 | Flange Nut 1/4"-20 | 7 |

A2100 6512 Box Assembly / Standard Model

Exploded Parts View

| Item # | Part # | Desc. | Qty. |
|--------|--------|--|------|
| 1 | A2226 | 6512 Box Assy. / Base Model | 1 |
| 2 | R1053 | Decal / Caution | 1 |
| 3 | R0022 | Decal / Built In The USA / Lg | 1 |
| 4 | R0026 | Decal / Operation | 1 |
| 5 | R1069 | Decal / Warning - Turn Off Blower | 1 |
| 6 | R1054 | Decal / Important Check Hoses | 1 |
| 7 | R1051 | Decal / Warning - Use Hearing Protection | 1 |
| 8 | R1055 | Decal / To Dump Grass | 1 |

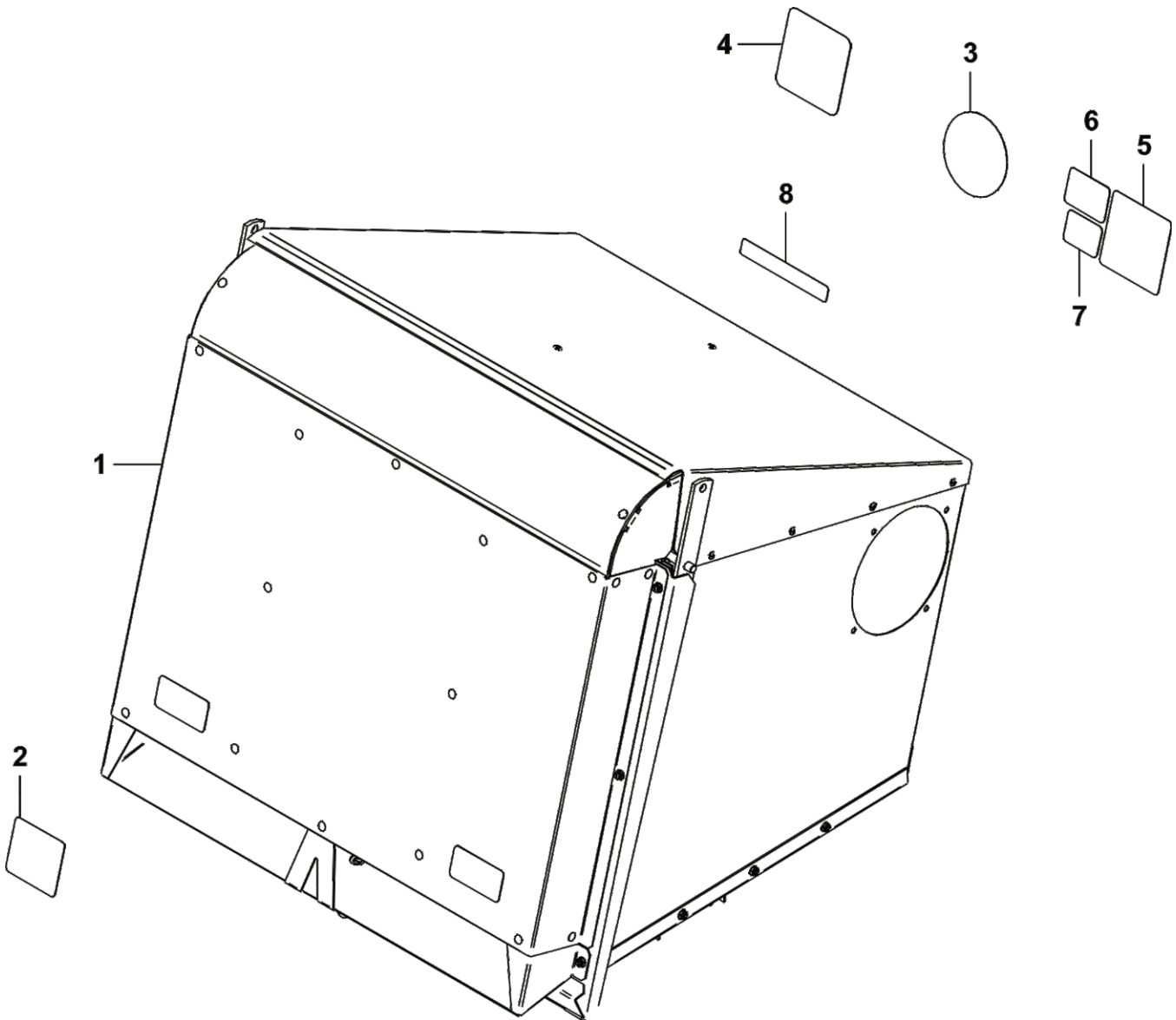

A2226 6512 Box Assembly / Base Model
Exploded Parts View

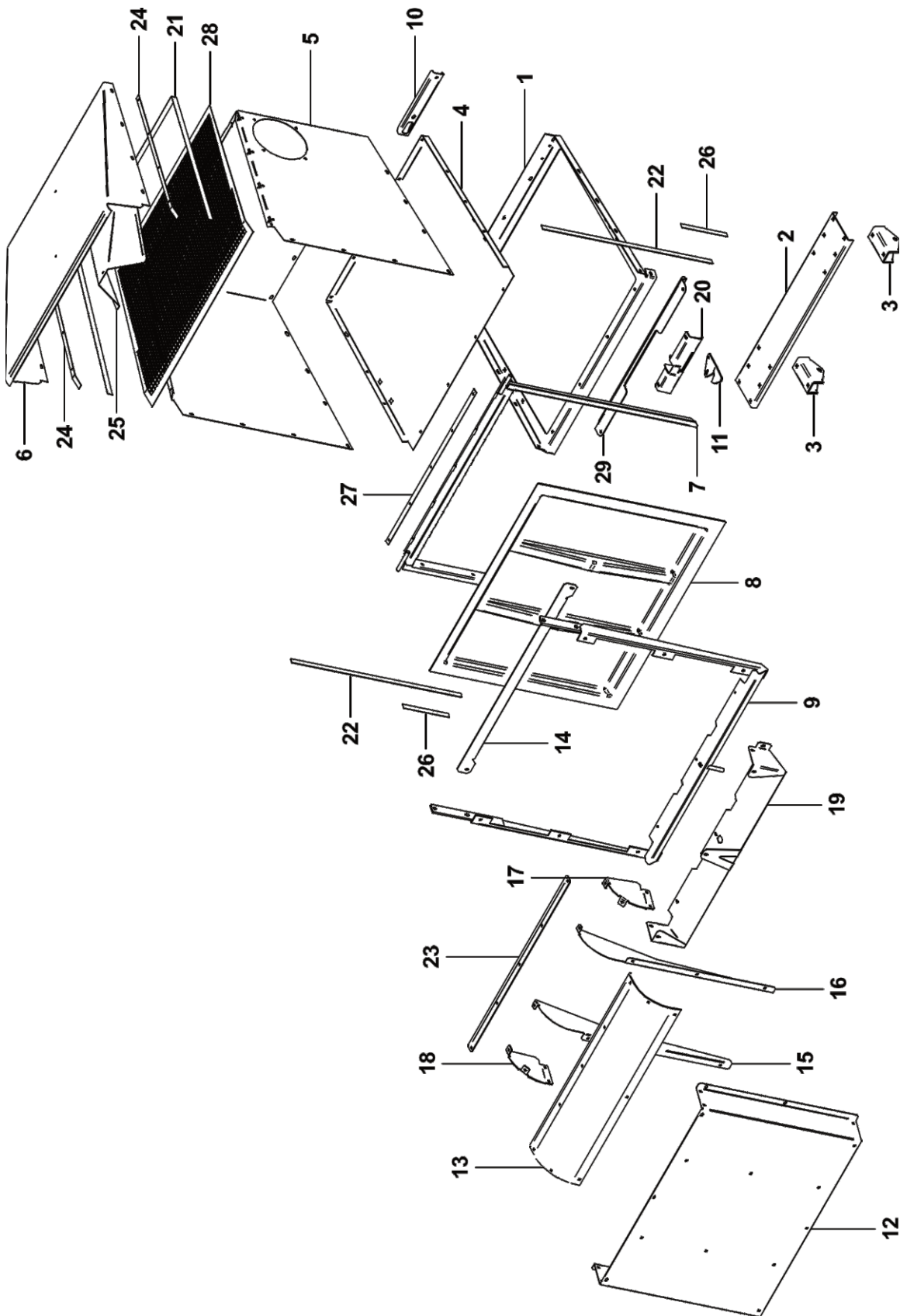

A2226 6512 Box Assembly / Base Model**Exploded Parts List**

| Item # | Part # | Desc. | Qty. |
|--------|--------|---------------------------------|------|
| 1 | B1750 | Base Frame | 1 |
| 2 | B1727 | Base Frame Pivot Mount | 1 |
| 3 | B1574 | Pivot Bracket | 2 |
| 4 | C0024 | Box Bottom | 1 |
| 5 | C0080 | Box Back & Sides | 1 |
| 6 | C0081 | Box Top | 1 |
| 7 | A0938 | Frame Weldment / Box Opening | 1 |
| 8 | V1131 | 12 Box Door | 1 |
| 9 | A0738 | Frame Weldment / Door Stiffener | 1 |
| 10 | B1730 | Latch Handle Mount Bracket | 1 |
| 11 | B0996 | Latch Hook | 1 |
| 12 | C0075 | Dust Diverter | 1 |
| 13 | V0051 | Dust Flap | 1 |
| 14 | B3688 | Upper Door Member | 1 |
| 15 | C0076 | Left Dust Diverter Brace | 1 |
| 16 | C0077 | Right Dust Diverter Brace | 1 |
| 17 | C0079 | Right Outer Dust Flap Brace | 1 |
| 18 | C0078 | Left Outer Dust Flap Brace | 1 |
| 19 | B0991 | Dust Diverter Guard Bracket | 1 |
| 20 | A2104 | Latch Mount Plate Assy. | 1 |
| 21 | V0052A | Dust Seal / Top Sides | 1 |
| 22 | V0052B | Dust Seal / Long Door Sides | 2 |
| 23 | B1006 | Dust Flap Stiffener | 1 |
| 24 | B1007 | Screen Clamp Strip / Side | 2 |
| 25 | C0087 | Screen Support | 1 |
| 26 | V0052C | Dust Seal / Short Door Sides | 2 |
| 27 | B1008 | Screen Clamp Strip / Rear Door | 1 |
| 28 | B8113 | Screen / Steel Wire Mesh | 1 |
| 29 | B2021 | Box Stop / 6512 | 1 |

A2107 Latch Rod Assembly

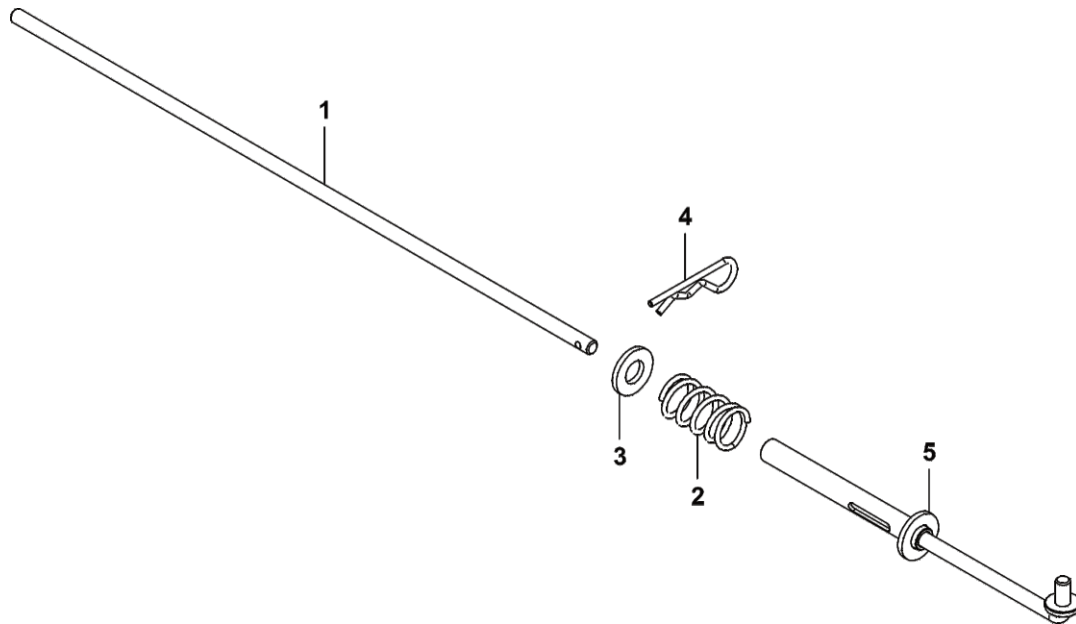

| Item # | Part # | Desc. | Qty. |
|--------|--------|--|------|
| 1 | B1000 | Latch Rod / Hook Side | 1 |
| 2 | J0303 | Spring | 1 |
| 3 | K0400 | 1/2" Flat Washer 1.084 OD x .528 ID x .120 T | 1 |
| 4 | K0086 | Hair Pin Clip .125 OD x 2.50 | 1 |
| 5 | A2106 | Latch Rod Weldment | 1 |

Unit Model #: 38651203

Mower: Dixie Chopper Eagle HP / Jacobsen ZT1000

Owner's Manual: Q0588

Mower Type:

Deck Size: 72"

Deck Type:

Vac Type: (12 Cu-Ft) Pro 12 DFS

Drive Type: PTO-X Drive

Fits Year(s): 2021 - Newer

Revision #: 1 - PTOX 1.5 - BS 7/18/24

PECO
Pack Drawing

A2395 Vac Kit

- (1) HB0831 Vac Kit HW Bag
- (1) C0088 Debris Deflector
- (1) C0074 Inlet Ring (Split Cut)
- (1) V0025 6" & 7" Inlet
- (2) J0060 6" Hose Clamps
- (1) A2100 12 Cu. Ft. Box Assy
- (1) A1192 Main Frame Assy
- (1) A0897 Box Handle Assy.
- (1) A2107 Latch Rod Assy.
- (2) B2526 Door Linkage
- (1) F0060-30 6" x 30" Upper Hose
- (1) B2599 Right Main Frame Leg
- (1) B2600 Left Main Frame Leg

A2393 Mount Kit

- (1) B2597 Top PTO Mt. Plate
- (1) B2598 Bottom PTO Mt. Plate
- (1) B2595 Right / Top Frame Bracket
- (1) B2592 Rear Frame Bracket
- (1) B2596 Left / Top Frame Bracket
- (1) B2594 Left Frame Bracket
- (1) B2593 Right Frame Bracket
- (1) C0124 Exhaust Shield / Top
- (1) C0125 Exhaust Shield / Bottom
- (1) A2067_02 Idler Mount Assy.
- (1) A2069_02 Belt Guard Assy.
- (2) J0080 8" Hose Clamps
- (1) F0080-45 8" x 45" Lower Hose
- (1) E6009 8" Blower Cone
- (1) B2601 Switch Mount Bracket
- (1) HB0863 Engine Pulley HW Bag
- (1) M0319 AK78 Belt
- (1) HB0864 Wire Harness Kit
- (1) HB0862 Mount Kit HW Bag
- (1) A2207 Mount Arm / Tube Assy.
- (1) A2061_03 Drive Assy W/ 4-Blade Impeller

A2375 Dual Weight Kit

- (2) Y0025 28 lbs Weights
- (1) HB0857 Weight Kit HW Bag
- (1) B2207 / Support Brkt
- (1) B2208 Caster Weight
- (1) B2209 Caster Weight / Brace
- (1) B2207 / Support Brkt
- (1) B2208 Caster Weight
- (1) B2207 / Support Brkt

A2376 Quad Weight Kit

- (1) HB0695 Weight Kit HW Bag
- (1) B2602 Quad Weight Bracket
- (4) Y0025 28 lbs Weights
- (1) B2602 Quad Weight Bracket

A2450 Boot Kit

- (1) E0044A 8" Boot W/ Decal
- (1) B0988 Boot Plate
- (1) HB0694 Boot Kit HW Bag
- (1) B0990 Boot Adapter

SAFETY DECALS

To promote safe operation, New PECO, Inc. supplies safety decals on all products manufactured. Damage can occur to safety decals either through shipment, use or reconditioning. Contact your local Service Center for replacement decals.



Part# R1070
PECO Logo



Part# R0022
Designed & Built
In The USA



Part #: R2007
Danger - Never Use Hands

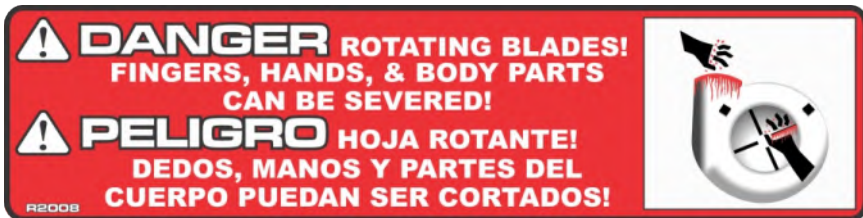

Part #: R2008
Danger - Rotating Blades

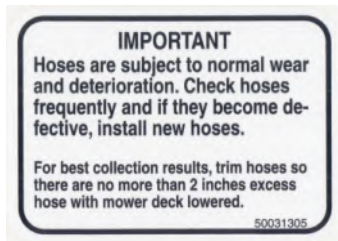

Part #: R1054
Important - Hose Wear

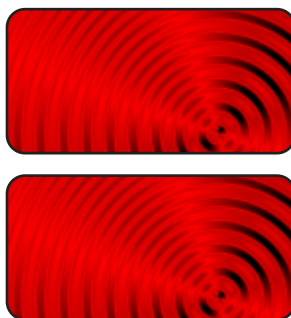

Part #: R1057 - (2)
Red Reflectors



Part #: R1069
Warning - Turn Off Blower



Part # R0024
Danger - Keep Hands
Clear



Part #: R1051
Warning - Hearing Protection



Part # R0025
Danger - Rotating
Blades

SECTION III

OPERATING INSTRUCTIONS

General Safety

Only qualified people familiar with this operator's manual and the mower's operator's manual should operate this machine.

Operation & Tips On Mowing

PTO-X Unit

- A. Perform BEFORE EACH USE the maintenance list referenced in Section IV.
- B. Start mower.
- C. With the mower at high idle speed, engage the mower deck.
- D. While seated in the operator's seat, move Bagger PTO switch to the on position. With the PTO assembly engaged, you can proceed to operate the control levers of the mower.

Engine Drive Unit

- A. Perform BEFORE EACH USE the maintenance list referenced in Section IV.
- B. Start the engine/blower/blade assembly.
- B. Start mower.
- C. With the mower at high idle speed, engage the mower deck.
- D. Proceed to operate the control levers of the mower.

NOTE: If the collection system does not appear to be collecting the grass clippings, disengage the deck and PTO assembly, then, engage the parking brake and turn the mower off. Check upper and lower hoses for any clogs.

To obtain the maximum effectiveness from your collection system, the tips listed below should be followed:

- * Watch your speed- Normal conditions will allow a speed of up to approximately 4 mph, but thick, heavy damp conditions will require reduced ground speed.
- * Mow with sharp blades- A sharp blade cuts cleaner.
- * Wet grass and leaves will decrease effectiveness and will increase horsepower requirements.

- * Mow at higher cutting heights- Remove and mulch no more than 2" of grass length with each mowing. (Experts recommend not cutting off more than 1/3 of the grass blade length at any given time.)
- * Mow twice, at different height settings, (high, then low), if grass is extra tall.
- * Remember that horsepower requirements will vary with the mowing conditions such as type and height of turf grass, moisture content, amount of leaves, whether the terrain is flat or hilly, etc.

Disengagement Of The PTO Assembly

- A. To disengage the PTO assembly, move PTO Rocker Switch to the off position.

WARNING: DO NOT TOUCH the PTO assembly, pulleys, or the belt until the tractor is turned off.

Unloading The Collection System

NOTE: Collection system blower will have an audible change in tone when the collection system is full.

- A. Stop the forward movement of the mower, engage the parking brake.
- B. Disengage the mower deck.
- C. Disengage the PTO assembly / set the throttle of the engine down to idle.
- D. Once the parking brake has been engaged, then and only then, walk behind the mower and check the collection bags by first unhooking the rubber strap with S-hook that secures the plastic top, then lift the plastic hood. Load in bags should not exceed the height of the installed bag.
- E. To remove the bags from the frame, slide bags out and turn bags over to deposit clippings.
- F. Slide empty bags back onto the frame and secure plastic top with the rubber strap with S-hook.

NOTE: Do not allow collection bags to become over-filled as potential damage may occur to your equipment. Also, be sure to clean the hood screen as needed.

SECTION IV MAINTENANCE

Maintenance Checklist

Before each use:

1. Check blades and spindles to be sure that no foreign objects, such as wire or steel strapping bands, are wrapped around them.
2. Inspect blades for wear. Replace if necessary. If it is necessary to sharpen the blades, remove the blades from the spindles before sharpening. **DO NOT** sharpen blades while still attached to the mower.
3. Make sure all shields are in place and in good condition. Repair or replace any missing or damaged shields.
4. Perform lubrication per instructions.
5. Listen for abnormal sounds, which might indicate loose parts, damaged bearings, or other damage. Correct any deficiency before continuing operation.
6. With the engine off, engage the blower assembly. Check the belt tension and inspect the pulley belt for cracks or tears.
7. Check for wear or deterioration of the upper or lower hoses. If there are any portions of the hose that have been torn or worn through, replace immediately.

After Each Use:

1. Clean all debris from machine especially from the container, underneath the belt shields, and safety decals. Replace any missing or illegible decals.
2. Inspect the unit for worn or damaged components. Repair or replace before the next use. Any replacement component installed during repair shall include the component's current safety decal specified by the manufacturers to be affixed to the component.

3. Under normal usage, the bag material is subject to deterioration and wear and should therefore be frequently checked for necessary replacement. Any replacement bag should be checked to ensure compliance with the original manufacturer's recommendations or specifications.

4. Check belt for proper tension.

Lubrication

Gearbox:

NOTE: The gearbox is filled with 6.0 oz. of Mobilube HD Plus 80W-90 oil and permanently sealed. There is no need for scheduled lubrication. The oil level should only be checked if a leak is observed or if a change in gearbox noise is noticed.

Operators are recommended to check for leaks weekly. If a leak is observed, both the gasket and the seals are recommended to be replaced.

Replace the oil using 5.5 oz. of the recommended Mobilube HD Plus 80W-90 oil. Be sure to not overfill.

Blower Assembly:

NOTE: The following is for older PTO models that contain a greaseable zirc fitting. Newer models contain maintenance-free bearings and are without a greasable fitting.

1. On initial use: Grease the fitting on the blower shaft.
2. Every 25 hours of use: Re-grease the grease fitting.

NOTE: Use only white lithium based grease for lubrication of the shaft on the blower assembly.

SECTION V - PARTS & SERVICE

Parts And Service Information

Collection system owners should record the name and telephone number of their Service Center. Your Service Center will be happy to supply replacement parts, accessories, and do any service or repairs to your collection system. If for any reason your Service Center is unable to service your collection system or supply replacement parts, contact New PECO, Inc. and include the following information on the chart below.

DOCUMENT THE FOLLOWING INFORMATION FOR FUTURE REFERENCE

Unit Model Number: _____

Unit Engine Size: _____

Unit Serial Number: _____

Date of purchase: _____ / _____ / _____

Dealer/Distributor Name: _____

Address: _____ **State:** _____ **Zip:** _____

Phone Number: _____

TORQUE SPECIFICATIONS

Proper torque for American fasteners used on PECO equipment.
Recommended Torque in Foot Pounds (Newton Meters).*

AMERICAN Bolt Head Markings

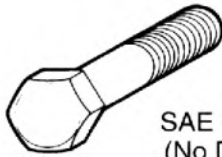

SAE Grade 2
(No Dashes)

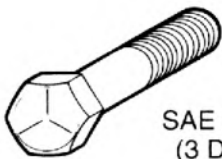

SAE Grade 5
(3 Dashes)

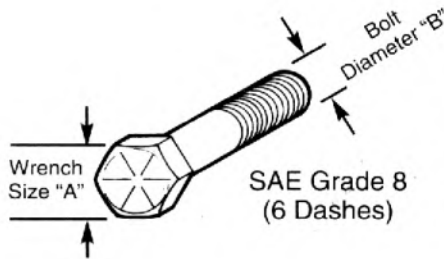

SAE Grade 8
(6 Dashes)

| WRENCH SIZE (IN.) "A" | BOLT DIAMETER (IN.) "B" AND THREAD SIZE | SAE GRADE 2 | SAE GRADE 5 | SAE GRADE 8 |
|-----------------------|---|-------------|-------------|-------------|
| 7/16 | 1/4 - 20 UNC | 6 (7) | 8 (11) | 12 (16) |
| 7/16 | 1/4 - 28 UNF | 6 (8) | 10 (13) | 14 (18) |
| 1/2 | 5/16 - 18 UNC | 11 (15) | 17 (23) | 25 (33) |
| 1/2 | 5/16 - 24 UNF | 13 (17) | 19 (26) | 27 (37) |
| 9/16 | 3/8 - 16 UNC | 20 (27) | 31 (42) | 44 (60) |
| 9/16 | 3/8 - 24 UNF | 23 (31) | 35 (47) | 49 (66) |
| 5/8 | 7/16 - 14 UNC | 32 (43) | 49 (66) | 70 (95) |
| 5/8 | 7/16 - 20 UNF | 36 (49) | 55 (75) | 78 (106) |
| 3/4 | 1/2 - 13 UNC | 49 (66) | 76 (103) | 106 (144) |
| 3/4 | 1/2 - 20 UNF | 55 (75) | 85 (115) | 120 (163) |
| 7/8 | 9/16 - 12 UNC | 70 (95) | 109 (148) | 153 (207) |
| 7/8 | 9/16 - 18 UNF | 79 (107) | 122 (165) | 172 (233) |
| 15/16 | 5/8 - 11 UNC | 97 (131) | 150 (203) | 212 (287) |
| 15/16 | 5/8 - 18 UNF | 110 (149) | 170 (230) | 240 (325) |
| 1-1/8 | 3/4 - 10 UNC | 144 (195) | 266 (360) | 376 (509) |
| 1-1/8 | 3/4 - 16 UNF | 192 (260) | 297 (402) | 420 (569) |
| 1-5/16 | 7/8 - 9 UNC | 166 (225) | 430 (583) | 606 (821) |
| 1-5/16 | 7/8 - 14 UNF | 184 (249) | 474 (642) | 668 (905) |
| 1-1/2 | 1 - 8 UNC | 250 (339) | 644 (873) | 909 (1232) |
| 1-1/2 | 1 - 12 UNF | 274 (371) | 705 (955) | 995 (1348) |
| 1-1/2 | 1 - 14 UNF | 280 (379) | 721 (977) | 1019 (1381) |
| 1-11/16 | 1-1/8 - 7 UNC | 354 (480) | 795 (1077) | 1288(1745) |
| 1-11/16 | 1-1/8 - 12 UNF | 397 (538) | 890 (1206) | 1444 (1957) |
| 1-7/8 | 1-1/4 - 7 UNC | 500 (678) | 1120 (1518) | 1817 (2462) |
| 1-7/8 | 1-1/4 - 12 UNF | 553 (749) | 1241 (1682) | 2013 (2728) |
| 2-1/16 | 1-3/8 - 6 UNC | 655 (887) | 1470 (1992) | 2382 (3228) |
| 2-1/16 | 1-3/8 - 12 UNF | 746 (1011) | 1672 (2266) | 2712 (3675) |
| 2-1/4 | 1-1/2 - 6 UNC | 870 (1179) | 1950 (2642) | 3161 (4283) |
| 2-1/4 | 1-1/2 - 12 UNF | 979 (1327) | 2194 (2973) | 3557 (4820) |

Proper torque for metric fasteners used on PECO equipment.
Recommended Torque in Foot Pounds (Newton Meters).*

METRIC

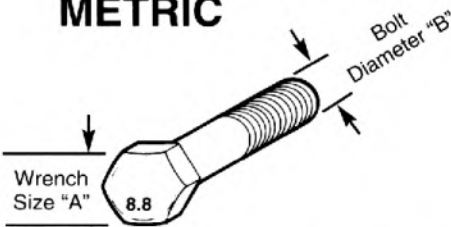

Numbers appearing on bolt heads indicate ASTM class.

| WRENCH SIZE (mm) "A" | BOLT DIA. (mm) "B" | ASTM 4.6 | ASTM 8.8 | ASTM 9.8 | ASTM 10.9 |
|----------------------|--------------------|-----------|-------------|-----------|-------------|
| 8 | 5 | 1.8 (2.4) | | 5.1 (6.9) | 6.5 (8.8) |
| 10 | 6 | 3 (4) | | 8.7 (12) | 11.1 (15) |
| 13 | 8 | 7.3 (10) | | 21.1 (29) | 27 (37) |
| 16 | 10 | 14.5 (20) | | 42 (57) | 53 (72) |
| 18 | 12 | 25 (34) | 74 (100) | 73 (99) | 93 (126) |
| 21 | 14 | 40 (54) | 118 (160) | 116 (157) | 148 (201) |
| 24 | 16 | 62 (84) | 167 (226) | 181 (245) | 230 (312) |
| 30 | 20 | 122 (165) | 325 (440) | | 449 (608) |
| 33 | 22 | | 443 (600) | | 611 (828) |
| 36 | 24 | 211 (286) | 563 (763) | | 778 (1054) |
| 41 | 27 | | 821 (1112) | | 1138 (1542) |
| 46 | 30 | 418 (566) | 1119 (1516) | | 1547 (2096) |

*Use 75% of the specified torque value for plated fasteners. Use 85% of the specified torque values for lubricated fasteners.

Troubleshooting

2017 (v1.0)

Collection System Performance

| Problem | Possible Cause | Corrective Action |
|--|--|--|
| Abnormal Vibration | <ul style="list-style-type: none"> • Cutting blades are bent or unbalanced • Loose blower pulley or pulley assembly • Impeller blade out of balance | <ul style="list-style-type: none"> • Install new cutting blade • Tighten the pulley • Contact dealer to replace |
| Reduced collection system performance | <ul style="list-style-type: none"> • Low engine speed • Plugged screen • Loose belt • Full collection bags | <ul style="list-style-type: none"> • Always operate collection system at full throttle • Remove debris, leaves, or grass clippings from the screen • Replace/tighten belt • Empty the collection bags |
| Blower and hoses plugging too frequently | <ul style="list-style-type: none"> • Collection bags are too full • Low engine speed • Grass is too wet • Grass is too long • Ground speed is too fast • Worn belt • Loose belt | <ul style="list-style-type: none"> • Dump more frequently • Always operate collection system at full throttle • Cut grass when it is dry • Cut the grass several times • Drive slower at full throttle • Replace belt • Adjust the pulley and tighten belts |
| Debris blowout | <ul style="list-style-type: none"> • Collection bags are too full • Plug/clog in the collection system • Ground speed is too fast | <ul style="list-style-type: none"> • Dump more frequently • Clean the collection system • Drive more slowly at full throttle |
| Impeller doesn't rotate freely | <ul style="list-style-type: none"> • Plug in the blower housing • Worn impeller blade • Shaft bearings bad/failing | <ul style="list-style-type: none"> • Clean the blower housing • Contact dealer to replace • Contact dealer to replace |



New PECO, Inc.

10 Walden Dr | Arden, North Carolina 28704

Phone: 1-800-438-5823 | 828-684-1234

Fax: 828-684-0858

Email: peco@lawnvac.com

Website: www.lawnvac.com